

Insulated Panels
Standing Seam Systems
UK & Ireland

Protected by



CHANGING THE ARCHITECTURAL LANDSCAPE

KingZip Linea & Infiniti Standing Seam Systems

The Kingspan logo, featuring a stylized horse head silhouette in gold above the word "Kingspan" in a bold, white, sans-serif font. A registered trademark symbol (®) is located at the end of the word.

Kingspan®

A NEW WAVE IN BUILDING DESIGN



Bunjil Place, Narree Warren, Victoria , Australia
Architects: FJMT

The success, natural beauty and longevity of future buildings, belongs to those shaping the future of construction today.



A New Wave In Building Design	2	Technical Data	18
Make Your Vision A Reality	4	– KingZip Linea & Infiniti	20
Architecture Inspired By Nature	6	– Typical Construction Solutions	22
Changing The Lay Of The Land For Design Flexibility	8	– System Options & Halters	24
KingZip Linea	10	– Structural Decks	25
KingZip Infiniti	12	Reaching New Heights	26
Finishes & Coatings	14	Integrated Solutions	28
Globally Mobile	16	Your Global Partner	30
		360° Service & Support	32
		Service Hubs	36
		Planet Passionate	38

MAKE YOUR VISION A REALITY

To realise a true architectural vision, it's vital to look beyond convention. Beyond the formulaic and functional shapes built around us, and to the shapes of nature that have formed around us.

Our freeform building envelope solutions are a celebration of nature's architecture and have been designed to maximise flexibility and versatility to help you reach unstoppable heights and bring your architectural vision to life.

Dee Why PCYC, NSW, Australia.
Architect: FJMT

ARCHITECTURE INSPIRED BY NATURE WITH KINGZIP

Nature always finds a way. And our KingZip Freeform Building Envelope Solutions do the same. Enabling you to fulfil design intent with total flexibility from initial form finding to construction without compromise.

Abu Dhabi International Airport Midfield Terminal, UAE
Architect: Kohn Pedersen Fox Associates

CHANGING THE LAY OF THE LAND FOR DESIGN FLEXIBILITY

Our systems offer the ultimate in design flexibility.

Our KingZip Freeform Building Envelope Solutions fully integrate with our insulated roof, wall and façade systems and accessories to provide a single source, high performance, fully guaranteed package.

KingZip Linea and Infiniti are manufactured on-site, from 1 metre up to 150 metres, allowing envelopes to be constructed using very long sheet lengths, eliminating the need for any endlaps and considerably increasing speed of construction.

Our systems are available in two application formats:

- KingZip Linea for 2D
- KingZip Infiniti for full 3D geometric envelope capability

KingZip systems provide advanced structural, thermal, acoustic and fire performance combined with interlocking seams offering exceptional long term weatherisation and durability.

KINGZIP LINEA

KingZip Linea gives you full flexibility to create functional and technically perfect convex, concave and angular architectural roof shapes.



KINGZIP INFINITI

KingZip Infiniti offers virtually unlimited design capability to develop sophisticated envelopes that are artistic and creative.



KINGZIP LINEA

KingZip Linea enables you to realise building envelope designs with total flexibility, creating technically perfect angular, convex, concave and tapered architectural forms.

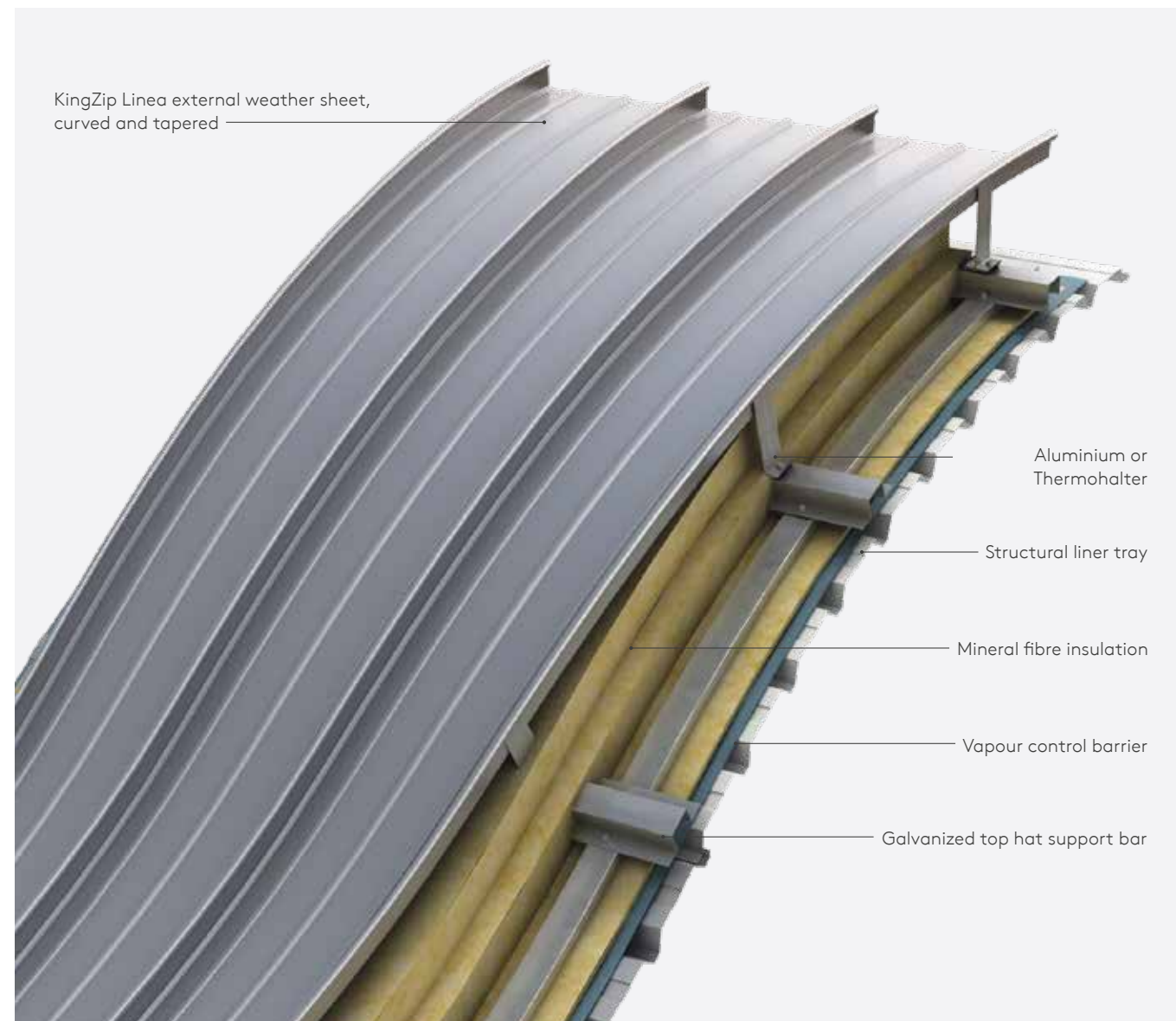

Dubai Sports City, UAE
Architect: Godwin Austen Johnson

KingZip Linea 300

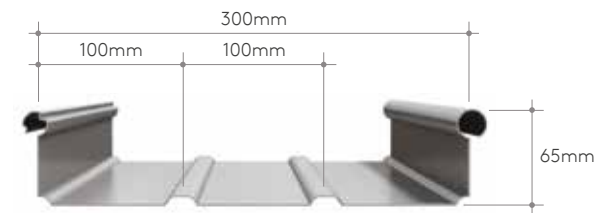

KingZip Linea 400

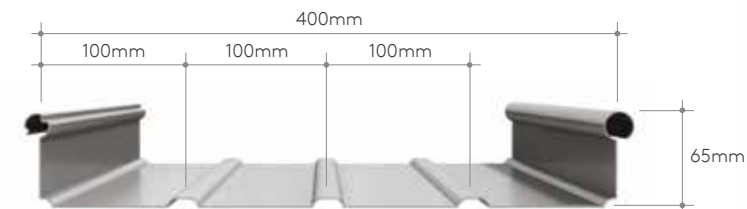

KingZip Linea 500

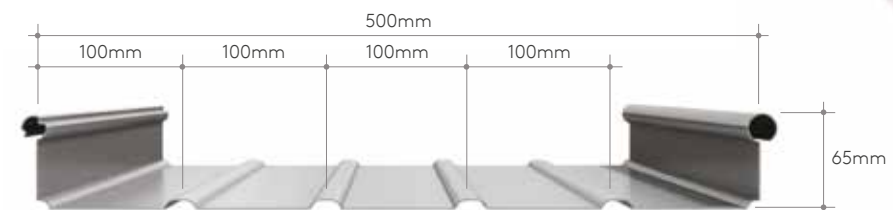

KINGZIP INFINITI

KingZip Infiniti offers you unprecedented freedom to create extraordinary 3D geometric buildings with complex shapes and forms – taking design and construction of the building envelope to new levels.

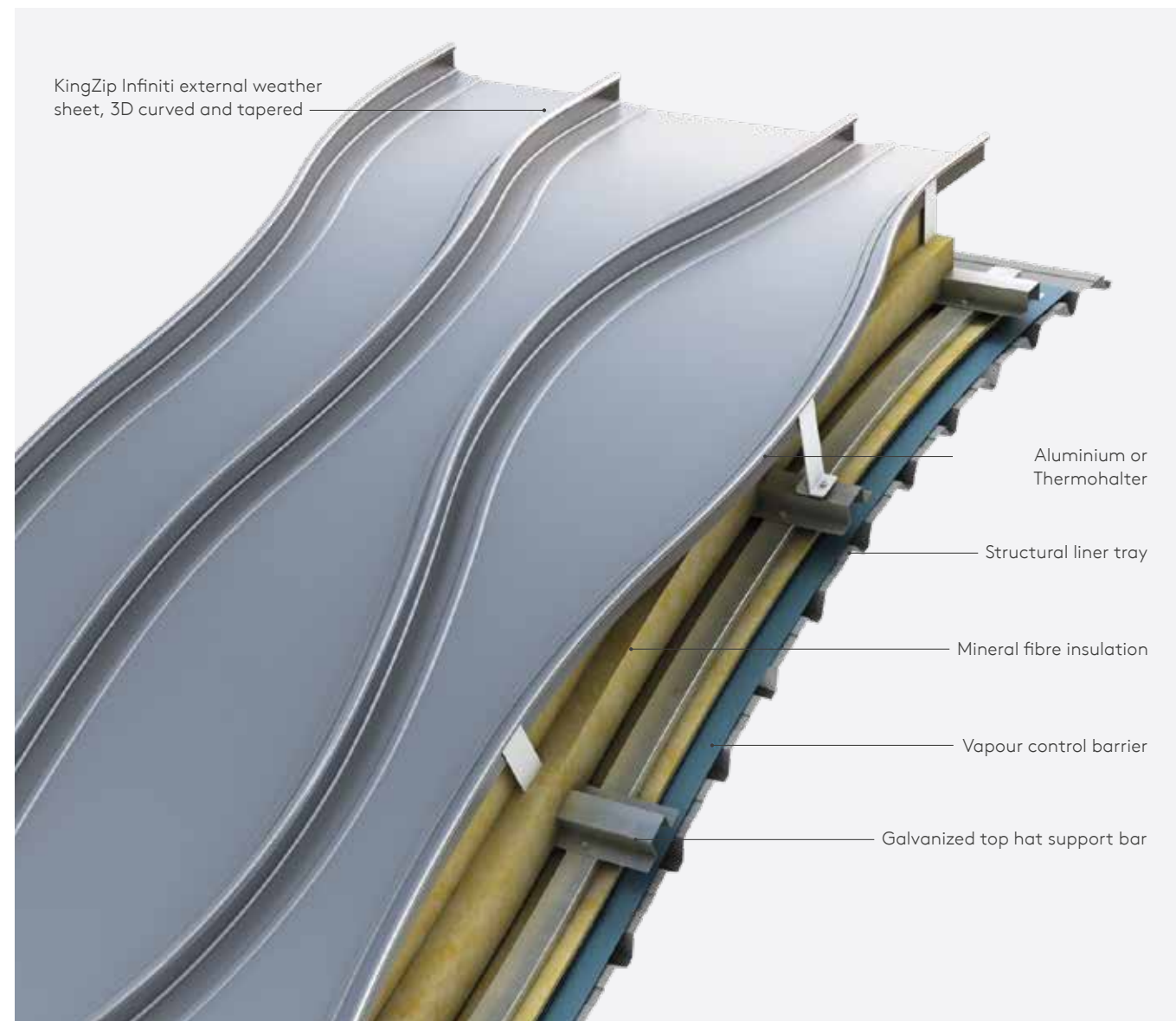

Our unlimited manufacturing capability of KingZip Infiniti enables you to realise distinctive and individual buildings that showcase creative and artistic vision on a global stage.



KingZip Infiniti



Finishes and coatings play a huge part in architectural design and are a key part of our world. KingZip Infiniti offers unparalleled architectural and technical performance capability combined with a wide range of finishes and materials.

External Weather Sheet

The external weather sheet is available in coated 3000 or 5000 series aluminium alloy or mill finish aluminium, stucco embossed mill finish aluminium, coated / pre-painted Z275 galvanised steel, stainless steel, zinc or copper with the following finishes:

Kingspan PVDF

Provides a long-term aesthetic life of approximately 20 years on aluminium, offering excellent durability and colour stability.

Kingspan ARS

Abrasion resistant coating for aluminium with good handling characteristics.

Kingspan Polyester

A cost-effective colour coating with a medium term life for both aluminium and steel.

Kingspan Anodised

Anodising is an electro-chemical process where the surface of the aluminium is modified to create a very hard, but still flexible and transparent layer. Anodized metal does not lose its coating, which grows integrally from the base aluminium and thus neither peels nor flakes, permanently sealing

the aluminium roofing underneath against the elements. Anodized coatings will have a smooth metallic look and feel and they can be dyed to almost any colour.

Kingspan Spectrum

Spectrum is an innovative 120 micron paint system with a unique heavy duty anti-corrosive primer and polyamide modified polyurethane final coat, that can be offered for more harsh and corrosive atmospheres.

Materials and Coatings Durability

The lifespan of a metal coating is determined by the geographical location, the local environment, the colour selected and the coating type.

For further information on any aspect of the technical data for KingZip Linea or Infiniti, please contact us at kingzip@kingspan.com



Choose from a wide range of standard coatings or, for that extra individuality or corporate identity, talk to us about colour and finish options tailored to your specific needs.

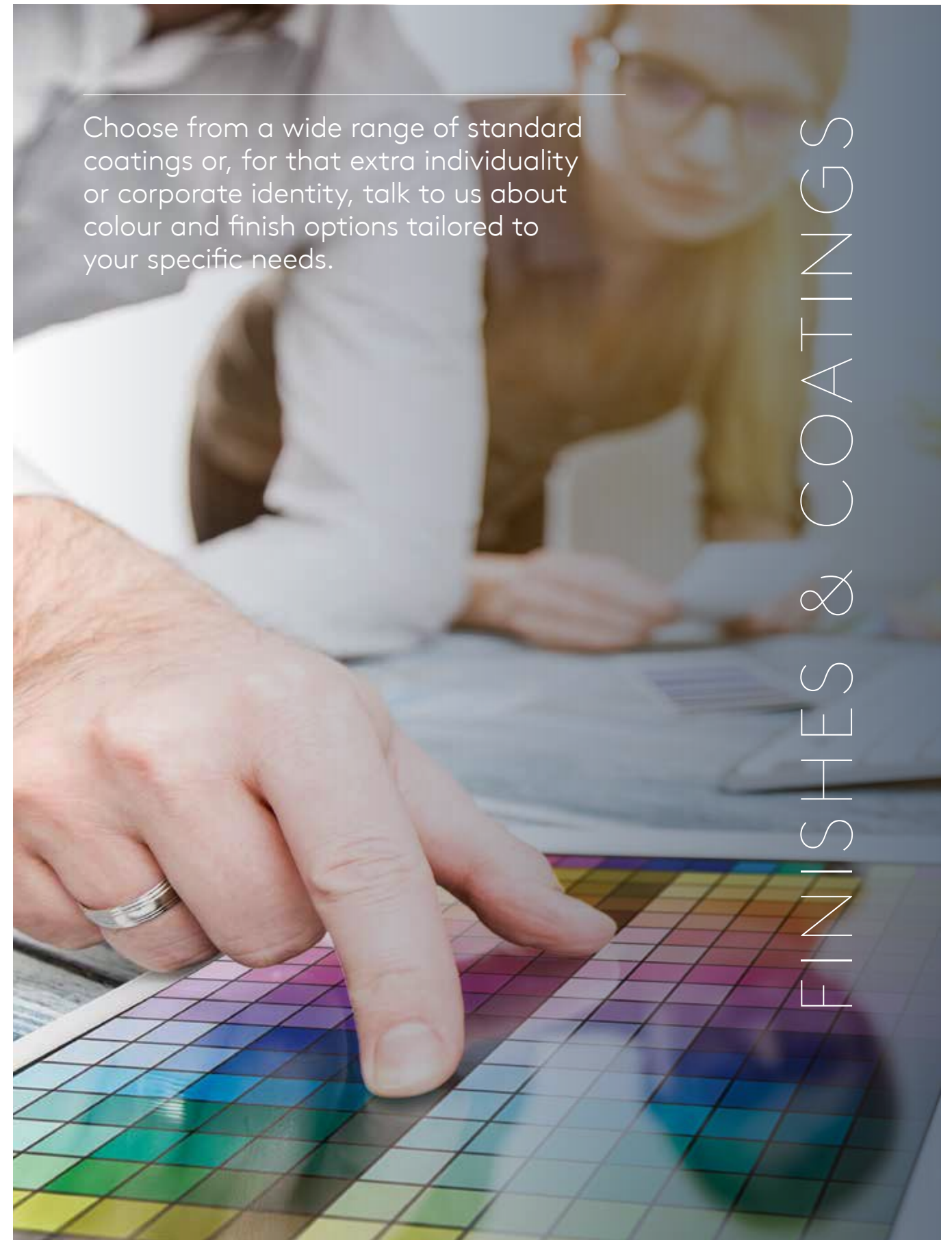

Both KingZip Linea and Infiniti are manufactured on site using mobile facilities that can be deployed anywhere in the world. This enables your design requirements to be fulfilled in terms of aesthetics, specification, performance and construction.

Our propriety CAD / CAM software ensure direct data transfer from our technical service centre to on-site production. This enables details to be changed cost effectively during production on-site.



Design



On-site Manufacture



_globALLY MOBILE



Assured long-term weatherisation throughout worldwide climate zones.

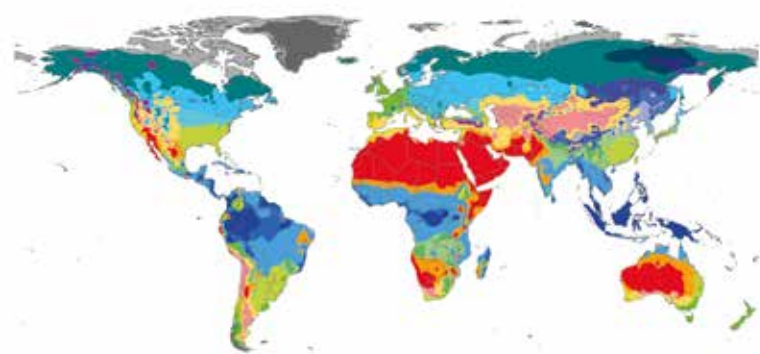

As advanced 'zip-up' freeform building envelope solutions, KingZip Linea and Infiniti create continuous weather-tight envelopes and are supplied as complete packages with outer weather sheet, structural liner, vapour barrier, insulation, thermal breakers, fasteners and accessories.

The technical performance of these systems sets the standard for compliance with national and international building codes and regulations, and can be tailored to meet specific or enhanced project criteria, such as seismic, thermal, acoustic and sustainability specifications.



Design, Technical, Commercial & Construction Assist Service.

Wide range of high performance materials, colours and coatings.

Can be smooth curved to 5m convex (KingZip Linea) or 1m convex (KingZip Infiniti) and 12m concave radii.

Can be tapered and smooth curved.

Tapered sheets can be manufactured on site, using fully automated equipment, in cover widths from 250mm to 500mm for KingZip Linea and 150mm to 800mm for KingZip Infiniti.

Site-welded watertight interface junctions and penetrations (aluminium only).

Fabrications service for customised accessories.

BS EN ISO 9001 (Quality Management) approved systems.

Factory Mutual FM 4471 approved and systems with UL 580-90 certification and ETA (DIBT) documentation available.

Green building sustainability code(s) compliant.

Approved installer network.

TECHNICAL DATA

Technical Data

KingZip Linea & Infiniti

Weatherisation & Durability

Both KingZip Linea and Infiniti provide proven exceptional weatherisation performance, with aluminium options being the preferred choice for highly demanding environments such as airports, marine, industrial and urban locations.

Inherently durable, aluminium offers almost maintenance-free weather-resistance performance, creating an inert oxidised layer that is highly resistant to corrosion and most pollutants, and is non-sensitive to UV for the lifetime of the building.

Site Welding

Enhanced lifetime weatherisation performance is achieved by site-welded watertight interface junctions and penetrations (aluminium only).

Structural Performance

Both KingZip Linea and Infiniti are high load-bearing structural solutions, suitable for projects worldwide, including seismic code specific applications.

Thermal & Airtightness Performance

KingZip Linea and Infiniti systems can be customised to any insulation specification requirements with thermal values from 0.11 W/m²K. A range of high performance insulation products is available to meet individual project demands, including man-made mineral fibre (MMMF) and fire-rated insulation board.

KingZip Linea and Infiniti systems have been subjected to CWCT and ASTM E1680 and achieve 5m³/hr/m² @ 50 Pa.

Acoustic Performance

Acoustic performance is a key requirement on many projects, especially public use buildings. KingZip Linea and Infiniti systems have the flexibility to meet the acoustic performance specification for any building.

Sound Reduction – Rw values from 36dB to 50dB.

Sound Absorption - NRC values from 0.5 to 0.85 for our standard perforation patterns. Project specific NRC values on request.

Acoustic Board – Gypsum Board 720 kg/m³ density, Cement Board 1,250 kg/m³ density or specific high density rubber mat.

Structural Liner Decks & Trays

Manufactured from high grade steel, our internal structural liner deck and tray ranges provide economical solutions for a wide variety of span requirements. Profiles can be perforated for enhanced acoustic specifications, and can support increased insulation levels for more rigorous acoustic requirements.

Environmental

Sustainability is firmly at the heart of Kingspan’s approach. We don’t just manufacture and supply sustainable products and systems such as KingZip, we also aim to operate within a sustainable business. We have made a commitment to ensure that all our facilities are Net-Zero Energy by 2020, with an interim target of 50% already exceeded. Our KingZip roof systems are manufactured and supplied under ISO 14001: 2004.

Vapour Control Layer (VCL)

Vapour Control Layers are an important part of the KingZip roof systems. We offer a range of VCL options to suit roof construction and specification, including options for high humidity / high occupancy projects.

Fire Performance

KingZip Linea and Infiniti systems both achieve a Class 0 rating as defined in various national building regulations. These systems are classed as non-combustible.

Test	Result
BS 476-3: 2004 Classification and method of test for external fire exposure to roofs	FAA / SAA
BS 476-6: 2009 Method of test for fire propagation for products	I < 12 i < 6
BS 476-7: 1997 Method of test to determine the classification of the surface spread of flame of products	Class 1 Rating for aluminium / steel inner / outer metal facings
FM 4471 Panel Roofs	Class 1

KingZip Linea Outer Profile Dimensions

Nominal Gauge (mm)	0.8, 0.9, 1.0 & 1.2
Panel Length (m)	1.5 to 150*
Standard Cover Width (mm)	300, 400 & 500**

* Can be manufactured on or off site. Factory manufactured up to a standard length of 15m (13.7m in Australia due to transport limitations). Please contact our Technical Department for further information.

** KingZip Linea 500 must be used only in a fully supported system. Other widths are available on request.

Please contact Kingspan for outer profile specifications for KingZip Infiniti.

KingZip Linea Typical Weights: Aluminium

Cover Width	0.9mm		1.2mm	
	kg/m²	kg/lm	kg/m²	kg/lm
300mm	3.87	1.16	5.13	1.54
400mm	3.53	1.41	4.70	1.88
500mm	3.34	1.67	4.44	2.22

Please contact Kingspan for weight specifications for KingZip Infiniti.

Product Tolerances

Cover Width	+2mm / -2mm
Edge Squareness	1% of sheet cover width
- up to 10m long	+10mm / -5mm
- over 10m long	+10mm* / -5mm

* +1mm per metre length over 10m.

Testing, Standards & Approvals

KingZip Linea and Infiniti are produced to the highest quality standards including BS EN ISO 9001. These products have been designed to fulfil a specific application and are manufactured to precise standards and tolerances, fully compliant with ASTM E1637 and FM 4471.

Systems with UL 580-90 certification are available. DIBt (ETA) – European Technical Approval No. 305/2011. European Assessment Document (EAD) 200035-00-0302 available.

Quality Assurance

Our KingZip systems are manufactured under ISO 9001: 2008 procedures both off- and on-site. Our on-site manufacturing facilities have the same dimensional quality as factory production.

All quality testing undertaken on-site is aligned with our factory testing procedures and results.



Seismic Load Effects

Seismic design impact and analysis is the overall responsibility of the appointed project design team. However, Kingspan Academy engineers can assist with specific inputs related to KingZip envelope systems and connectivity to the main structure.

Lightning Protection

KingZip aluminium envelope systems provide safe, effective protection by either acting as a conductor or as a protective screen in the event of lightning strike, safely routing the charge to earth.

This prevents lightning strikes affecting the building structure and can counter the electromagnetic effect on both plant and equipment within the building.

When installing KingZip systems there is usually no requirement for dedicated or additional lightning protection devices, but KingZip sheets must be fully zipped and conductively connected to earth.

KingZip aluminium envelope systems can be used as lightning conductors in accordance with International Standard ENV 61024-1 Protection of structures against lightning – Part 1: General Principles, as the crimped seams of the sheets provide a permanent electric connection.

Safepro2

An innovative, discreet personal fall protection system, Safepro2 is designed to protect both the worker and the roof to which the system is fixed. Safepro2 is fully compliant to EN 795:C and uses force minimization technology which limits the load transferred to the roof to less 6kN.

Technical Data

Typical Construction Solutions

For project and performance specifications, please contact Kingspan.

KingZip insulated system on steel purlins

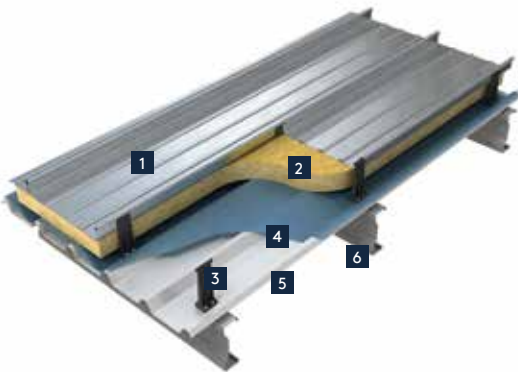

- 1. KingZip Linea / Infiniti Standing Seam
- 2. Single layer mineral wool insulation
- 3. Halter with thermal pad or Thermohalter
- 4. Vapour control layer (VCL)
- 5. Kingspan structural liner
- 6. Secondary steelwork - purlin

KingZip insulated system on structural liner deck

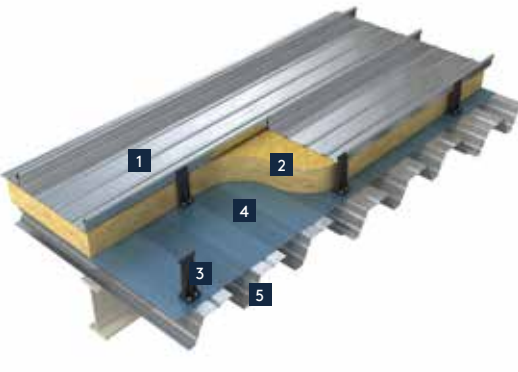

- 1. KingZip Linea / Infiniti Standing Seam
- 2. Single layer mineral wool insulation
- 3. Halter with thermal pad or Thermohalter
- 4. Vapour control layer (VCL)
- 5. Kingspan structural liner deck (can be perforated)

KingZip acoustic system on structural liner deck

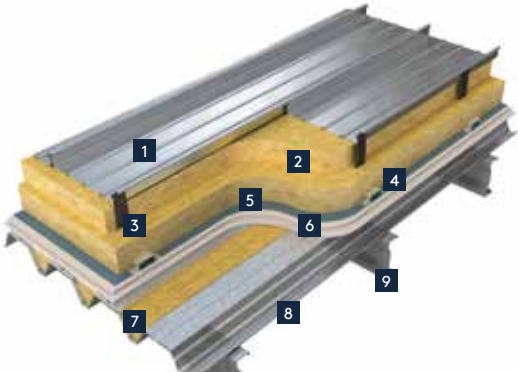

- 1. KingZip Linea / Infiniti Standing Seam
- 2. Double layer mineral wool insulation
- 3. Halter with thermal pad or Thermohalter
- 4. Galvanised top hat support channel
- 5. Vapour control layer (VCL)
- 6. Double layer acoustic plasterboard
- 7. Mineral wool insulation infill
- 8. Kingspan perforated structural liner deck
- 9. Secondary steelwork - purlin

KingZip acoustic system on structural liner deck

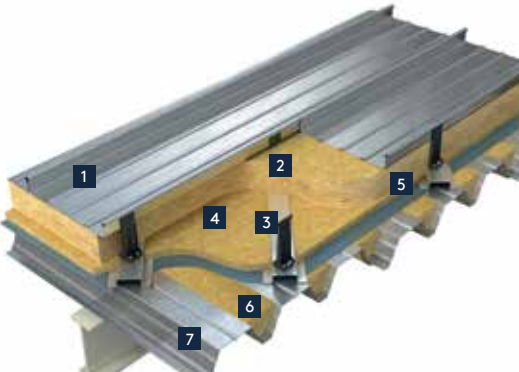

- 1. KingZip Linea / Infiniti Standing Seam
- 2. Single layer mineral wool insulation
- 3. Halter with thermal pad or thermohalter and support channel
- 4. Single layer mineral wool insulation
- 5. Vapour control layer (VCL)
- 6. Mineral wool insulation infill
- 7. Kingspan perforated structural liner deck

KingZip enhanced insulation system on structural liner deck

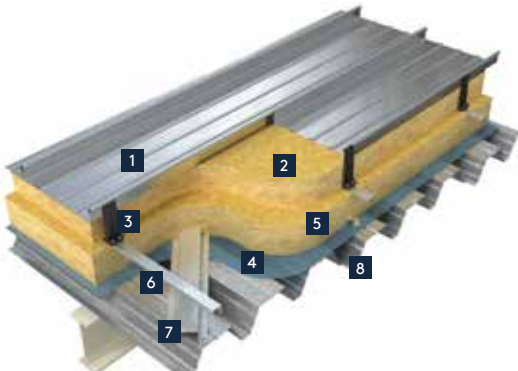

- 1. KingZip Linea / Infiniti Standing Seam
- 2. Single layer mineral wool insulation
- 3. Halter with thermal pad or Thermohalter
- 4. Vapour control layer (VCL)
- 5. Single layer mineral wool insulation
- 6. Quattro spacer system
- 7. Galvanised top hat support channel
- 8. Kingspan structural liner deck

KingZip enhanced insulation system on structural liner deck

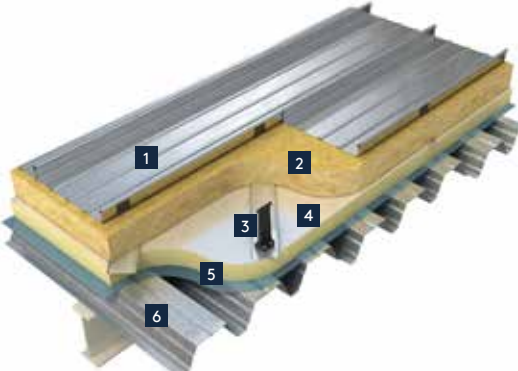

- 1. KingZip Linea / Infiniti Standing Seam
- 2. Single layer mineral wool insulation
- 3. Thermohalter and support channel
- 4. Single layer Kingspan TR26 foil faced PIR insulation board
- 5. Vapour control layer (VCL)
- 6. Kingspan structural liner deck

KingZip Roofliner Hybrid System

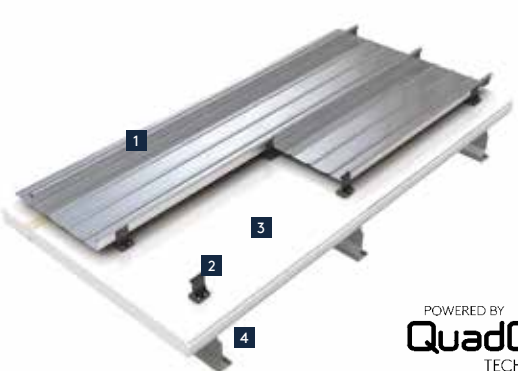

- 1. KingZip Linea / Infiniti Standing Seam
- 2. Halter with thermal pad or Thermohalter
- 3. Kingspan QuadCore™ Roofliner Panel
- 4. Secondary steelwork - purlin

POWERED BY
QuadCore
TECHNOLOGY

KingZip IP Standing Seam Roof Panel

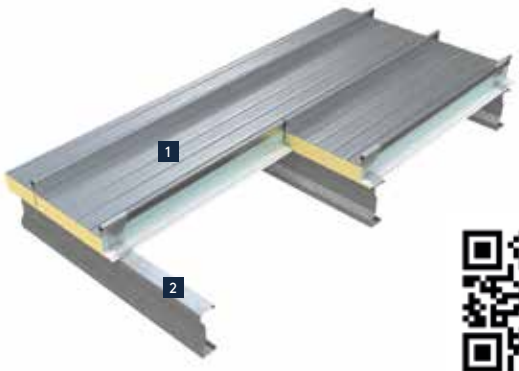

- 1. KingZip KS500/1000 IP Standing Seam Roof Panel
- 2. Secondary steelwork - purlin



Scan QR Code to find out more about our panelised standing seam solution.

Technical Data

System Options & Halters

Aluminium Halter Range (heights)

Maximum
245mm

Minimum
75mm



Thermohalter Range (heights)

Maximum
245mm

Minimum
85mm



KingZip Linea and Infiniti external weather sheets are secured to the supporting sub-structure with a range of extruded aluminium or thermohalters.

Extruded aluminium halters are supplied complete with pre-fitted thermal pads. Our 'thermohalters' provide enhanced thermal and acoustic system performance, mitigating thermal bridging through the roof assembly.

All halters are designed to accommodate free movement of the external weather sheet during thermal cycling, therefore permitting the application of very long sheet lengths.

Technical Data

Structural Decks

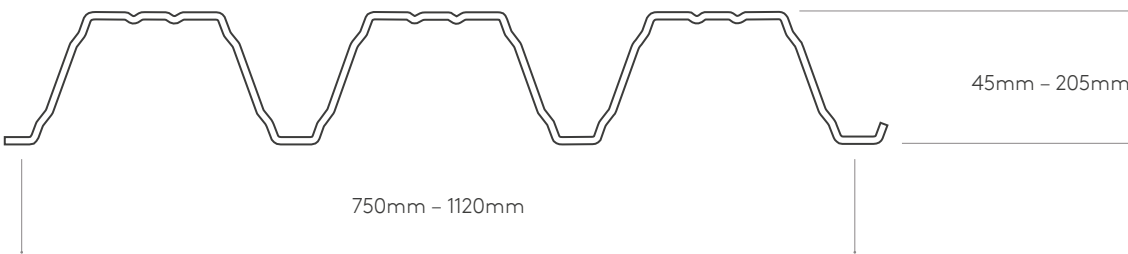

Please note: all Structural Liner Deck profiles can be perforated in the web.

Structural Liner Trays

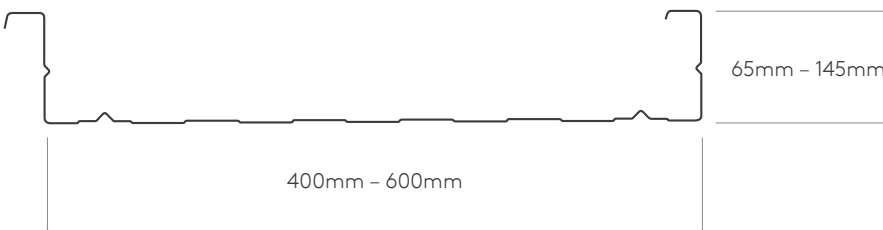

Please note: all Structural Liner Trays profiles can be perforated in the pan.

Acoustic Specifications

Both our Structural Liner Deck and Liner Tray ranges are available with two standard perforation options to suit acoustic sound absorption specifications. Perforations are applied to the web of Structural Liner Decks and the pan of Liner Trays. Project specific perforation configurations are available on request.

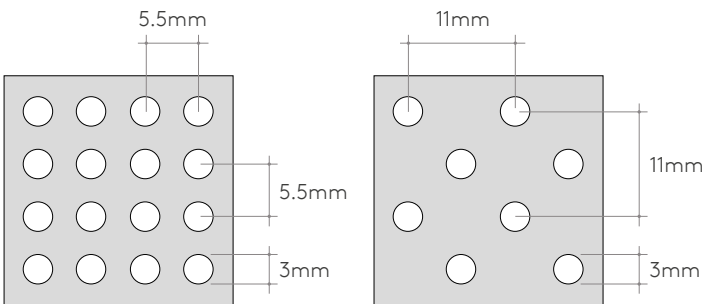

REACHING NEW HEIGHTS

Taronga Zoo, Sydney, Australia
Architect: Tanner Kibble Denton

kingspan.com

Integrated Solutions

Daylighting

Daylight is an essential natural asset. There is a significant body of evidence to suggest that buildings enjoying high levels of natural light are literally more successful than those more reliant on artificial lighting systems.

A proper daylighting plan can reduce electricity and HVAC (heating, ventilation, and air conditioning) costs.

We custom design and manufacture a range of integrated upstands, specifically for our KingZip systems, that accommodate a variety of daylighting solutions such as prismatic, domed and barrel vault options as well as 'in-plane' daylight methods.

Arcade Plus Rooflight

The Arcade Plus Rooflight is an energy efficient, thermally broken daylighting system with an arched aluminium and PVC profile structure. It is particularly suitable for more demanding installations with respect to insulation, sealing, and protection against condensation.

Arcade Plus Rooflight



Kingspan Day-Lite Kapture KS1500 DLK

Our first 100% diffusion roof light, designed to integrate with the KingZip roof system. The unique, contoured design of the Kingspan Day-Lite Kapture rooflight allows it to capture enhanced levels of natural light at low sun angles – illuminating internal spaces during early morning and late evening. Its advanced nano-prismatic technology efficiently scatters light ensuring excellent levels of light transmission and eliminating hot-spots and glare.

Day-Lite Kapture



Fall Arrest Safety System

We offer both our Safepro2 and KingZip SF Walkway safety systems for use with KingZip Linea and Infiniti.

They are the only systems that are fully tested and approved for use with KingZip and they comply with national and international codes and standards – providing the highest levels of protection within regulatory requirements.

Both systems allow for quick and easy, top-fix non-penetrative installation eliminating thermal bridging.

Safepro2

An innovative, discreet personal fall protection system, Safepro2 is designed to protect both the worker and the roof to which the system is fixed. Safepro2 is secured to the standing seam of KingZip systems using non-penetrative fixing clips, thereby maintaining integrity of the external weather sheet. Safepro2 comprises a high-strength stainless steel cable, supported on energy-absorbing roof anchor posts. Workers must wear an approved full body harness lanyard and attach themselves to the Safepro2 system.

Safepro2



KingZip SF Walkway

Kingspan aluminium walkways prevent roof panel damage caused by foot traffic by allowing a safe convenient access to and across the roof. Designed to complement KingZip, the walkways are fixed to the roof profile without penetration of the sheeting, maintaining KingZip system integrity.

KingZip SF Walkway



Integrated Solutions

Vents & Access Hatches

We custom design and manufacture a range of integrated upstands for vents, access hatches and other penetrations to project specific requirements.

Smoke Management

We manufacture the industry's most effective heat and smoke vents with multiple options for framing, glazing, listing and lifting loads providing high-performance fire-safety. Smoke safety is a primary consideration in any construction, Kingspan offer straightforward and effective smoke management solutions that integrate with the KingZip roof system.

Roof Access Hatch



Smoke vent



Energy Solutions – Solar PV

We deliver tailored rooftop solar PV systems, designed to maximise on-site energy consumption whilst protecting the structural integrity of your roof with our unique combined panel and PV warranty. Solar PV modules are installed on top of KingZip Linea/Infiniti standing seam system with the help of KingClips.

Solar PV mounted on KingZip

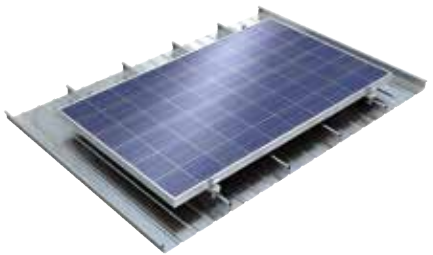

Kingspan Façade Systems

Kingspan Façade systems such as ACM cassette panels or Shingles can be mounted on top of KingZip standing seam system to achieve alternative architectural finishes while having a weatherproof non-penetrative base.

ACP / Mesh mounted on KingZip



Shingle mounted on KingZip



We want to work in a partnership with you from the outset to deliver innovative high performance architectural solutions for your projects.

The Kingspan brand has always been synonymous with high performance construction systems excellence. Our focus on stunning architectural design capability, fire performance, energy efficient building systems and long term durability has placed the company in a world leadership position as the most innovative providers of integrated architectural design solutions globally.

Kingspan has pioneered many innovations in the design and manufacturing of advanced building envelope systems, with sustainability of lifetime performance as a key focus. Today Kingspan provides building designers and architects with solutions to facilitate their creativity, to offer their clients striking buildings, from urban master plans through to breathtaking infrastructure and commercial projects.



Dubai International Airport Concourse 3, UAE
Architect: ADPI

At Kingspan, we deliver the industry's widest portfolio of support and services, both locally and globally. Designed to optimise the performance of the buildings, and backed by the knowledge and experience that only we can provide.

95+

commercial and service centres worldwide

100+

manufacturing sites worldwide

\$4.4 billion

revenue in 2018

13,000+

employees worldwide

Kingspan is a global leader in the design, manufacture and delivery of advanced building envelope systems and solutions.

YOUR GLOBAL PARTNER

KINGZIP SERVICE SUITE

Our technical support team will assist you with all the necessary design and engineering calculations required to realise your design intent. Below is a brief overview of the design services we provide to our customers:

1. Project Overview & Review:

We can undertake an initial assessment of the design intent (e.g. reviewing complex geometry) and scope of the project in order to evaluate suitability and capabilities of the product. It's important to provide technical guidance at early stages of the project to avoid constructability problems that may occur at later phases of the project and provide value engineering options to save time and money on your projects.



Successful realisation of a project not only depends on the quality of the product itself but also on the technical, commercial, training and supervision services provided at every stage. We offer a comprehensive suite of services to assist architects and contractors, from the initial concept design stage through to the eventual project handover.

2. Design Calculations:

We can provide all the necessary technical calculations required to design the most complex geometric envelopes, using our suite of in-house calculation tools which include:

- A. U-Value Calculations
- B. Acoustic Predictions
- C. Gutter Flow Calculations
- D. Structural Performance

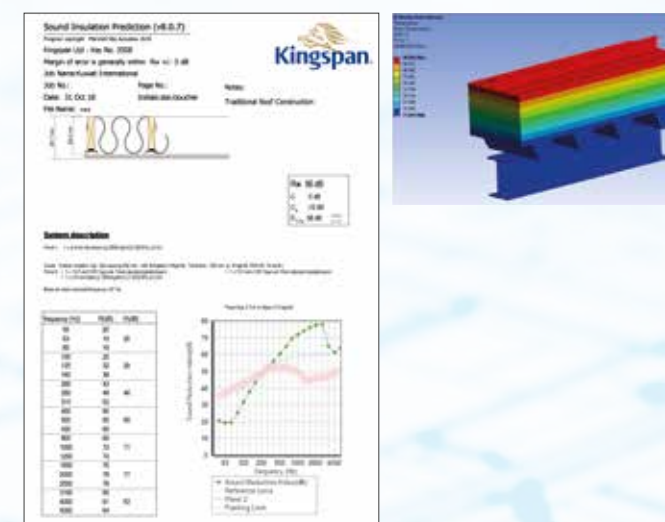

3. NBS/CSI Spec Development:

Our regional specification managers can assist you in developing local building code compliant NBS or CSI format specifications, tailor made for your project.



4. Shop Drawings & BIM Modelling:

This is an optional service made available to our customers on a project by project basis. This service includes:

- A. Development of shop drawings - either conceptual or detail design
- B. Development of non-standard construction details
- C. BIM Objects and Modelling design assistance as per International BIM standards

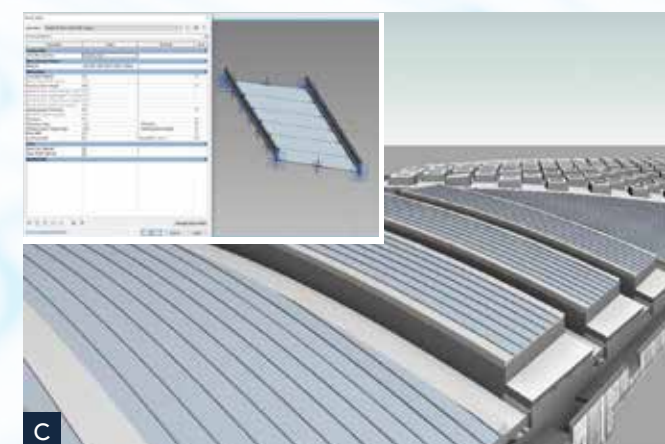

360° SERVICE & SUPPORT

KingZip Service Suite 360° Service Support

Site Inspections/Installer Training

Our field service engineers provide training on installation of KingZip systems for roofing contractors. The training includes:

- KingZip product and accessory introduction
- Product Handling
- 2D and 3D System installation best practices

Following the successful completion of training, roofing contractors will be issued with a KingZip Approved Installer Certificate.

We also offer pre-scheduled regular project site inspections to supervise the installation of our systems to ensure KingZip products are installed in line with design requirements, at the customer's request.

Samples

We can supply our standard KingZip product and accessory samples together with color swatches for all of the finish options available. In addition, we also offer bespoke sectional mockup samples, replicating the specified KingZip system that's being installed as part of your project.



Continuous Professional Development Program

Our CPD seminar, **"Factors to consider when designing standing seam roof systems"**, explores all the design considerations and performance criteria required to design high performance building envelopes using standing seam systems.

KingZip Warranty

Kingspan offers a comprehensive KingZip warranty for up to 30 years that includes paint coatings, metal substrate and structural performance for the supplied system.

To register your interest to attend a CPD seminar, please email us at kingzip@kingspan.com and one of our ASMs will contact you to arrange a date and time to suit you.

360° SERVICE & SUPPORT

Morin Corporation

685 Middle Street
Bristol
CT 06010
U.S.A.
T: +1 (860) 584-0900

Kingspan Limited

Greenfield Business Park No.2
Holywell
Flintshire
CH8 7GJ
United Kingdom
T: +44 (0) 1352 716100

Kingspan B.V.

Lingewei 8
4004 LL Tiel
Postbus 6565
4000 HN Tiel
The Netherlands
T: +31 (0) 344 675 250

**Kingspan Insulated Panels
Manufacturing LLC**

P.O. Box: 60493
Jebel Ali
Dubai Investments Park Dubai
UAE
T: +971 (0) 4-8854 232

**Kingspan Insulated Panels
Manufacturing LLC**

Singapore Branch
6 Penjuru Place
Penjuru Tech Hub #01-30
Singapore 608781
T: +65 96713103

**Kingspan Insulated Panels
Pty Ltd**

38-52 Dunheved Circuit
St Marys
NSW 2760
Australia
T: +61 (02) 1300 KINGSPAN
(1300 546 477)

SERVICE HUBS

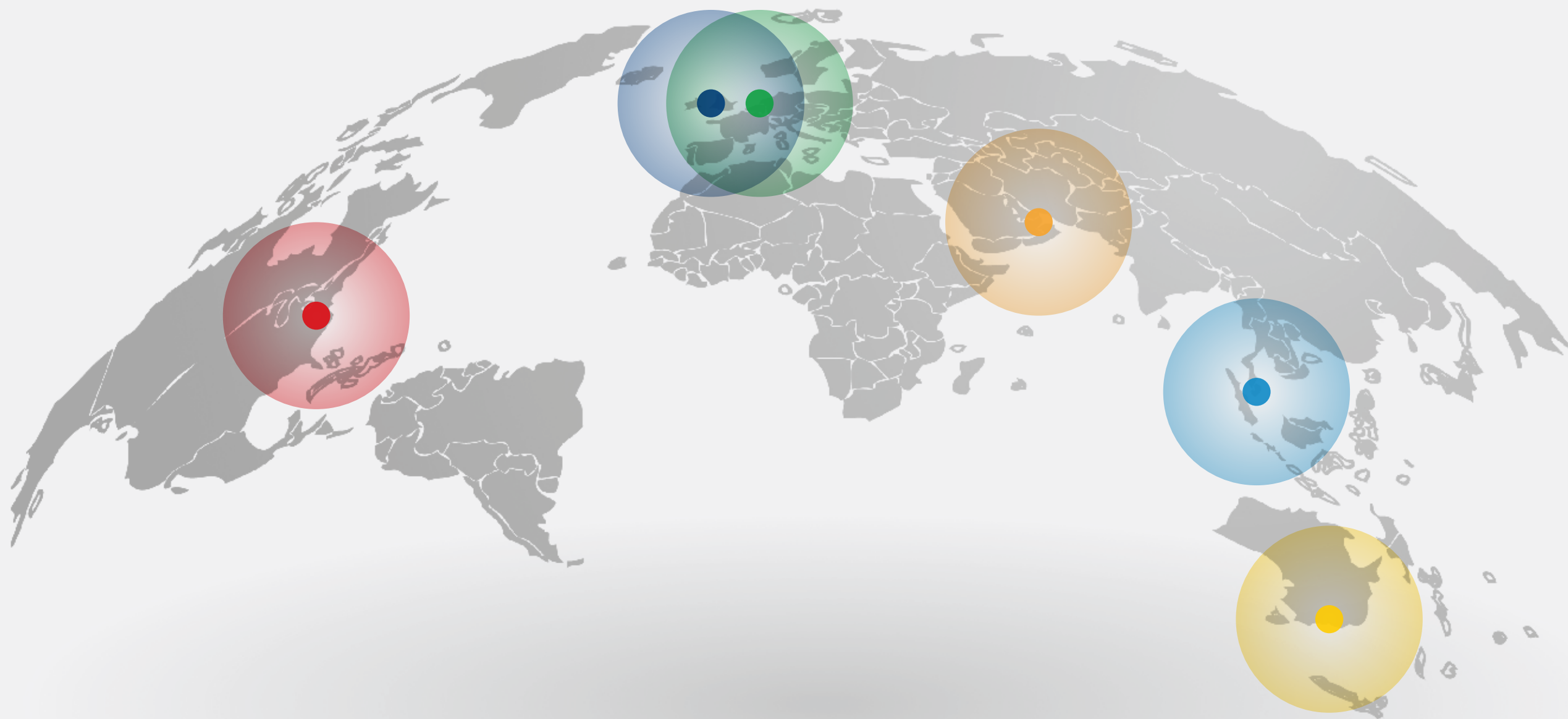

"Together we have the opportunity to make our built environments more energy efficient, attractive, adaptable, environmentally sensitive and productive. The way we build can be more effective and reach higher standards than ever before."

Gene M. Murtagh, Chief Executive Officer, Kingspan Group.

KingZip envelope systems can contribute to green building credits in the following key categories:

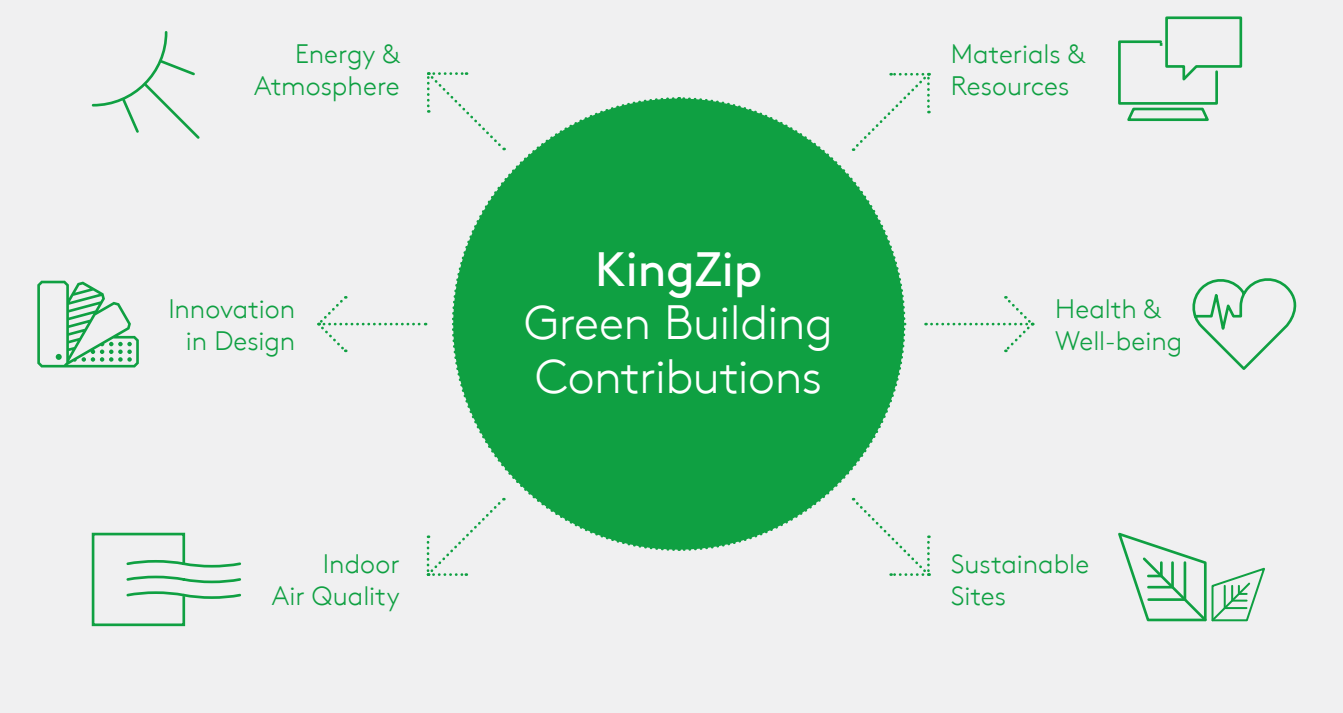

BREEAM®



Aluminium and steel are two of the most easily and widely recycled materials available.

Introducing our new 10-year groupwide sustainability programme that aims to impact on three big global issues: climate change, circularity and protection of our natural world.

"With Planet Passionate we are setting ourselves challenging goals for the next 10 years. We are committing to hard targets in the areas of energy, carbon and water reduction while enhancing the circularity of our products. This won't be easy, and will take serious leadership, commitment and effort across our group. I know we can, and must, make this happen."

Gene M. Murtagh, Chief Executive Officer, Kingspan Group.

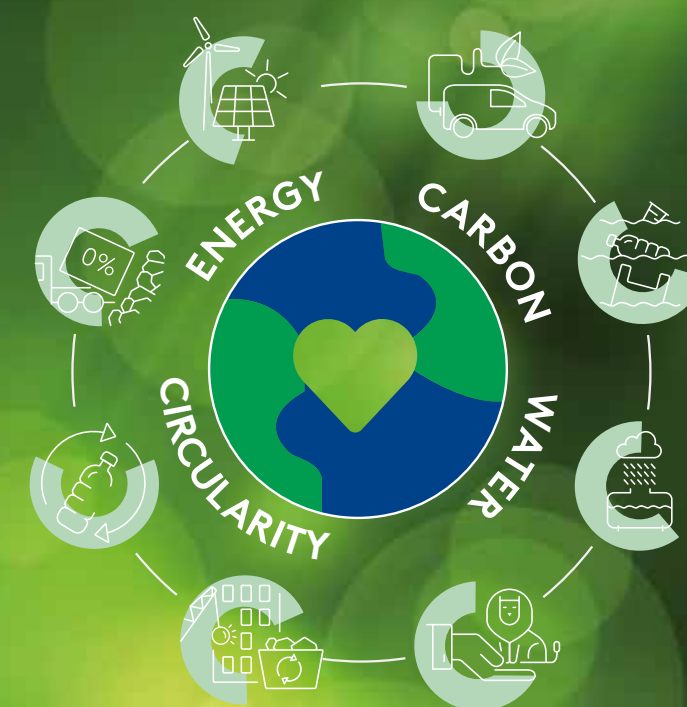

ENERGY

- › Maintain our Net Zero Energy target
- › Increase our direct use of renewable energy to 60%
- › Increase our on-site generation of renewable energy to 20%
- › Install Solar PV Systems on all Facilities

CARBON

- › Net Zero Carbon Manufacturing
- › Zero Emission ready Company Cars
- › 50% reduction in product CO₂ intensity from our primary supply partners

WATER

- › 5 Active Ocean Clean-up Projects
- › Harvest 100 million litres of rainwater

CIRCULARITY

- › Zero Company Waste to Landfill
- › 1 billion PET bottles upcycled into Insulation by 2025
- › All Quadcore™ Insulation to utilise upcycled PET by 2025

Are you Planet Passionate?

Find out about our Planet Passionate network.
Email planetpassionate@Kingspan.com



Contact details

Middle East, Africa, Turkey & Central Asia

**Kingspan Insulated Panels
Manufacturing LLC**
PO Box 60493
Dubai Investment Park Gate 1
Dubai | UAE

T: +971 4 8854232
E: info@kingspanpanels.ae
www.kingspanpanels.ae

UK & Europe

Kingspan Limited
Greenfield Business Park 2
Bagillt Road | Holywell
CH8 7GJ

T: +44 (0) 1352 716 100
E: kingzip@kingspan.com
www.kingspanpanels.co.uk

Americas

Morin Corporation
685 Middle Street | Bristol
CT 06010 | U.S.A.

T: +1 (860) 584-0900
E: kingzip@kingspan.com
www.kingspanpanels.com

South East Asia

Kingspan Insulated Panels Pty Limited
1 Commonwealth Lane #07-26
Singapore 149544

T: +65 6264 5942
E: infosea@kingspan.com
www.kingspanpanels.sg

India

Kingspan Jindal Pvt. Ltd.
Old Manesar Road | Narsinghpur
Gurgaon - 122001 | Haryana | India

T: +91 124 4393 200
E: sales@kingspanjindal.com
www.kingspanjindal.com

Australia

Kingspan Insulated Panels Australia
38-52 Dunheved Circuit
St Marys | NSW 2760

T: +61 (02) 8889 3000
E: info@kingspanpanels.com.au
www.kingspanpanels.com.au

New Zealand

Kingspan Limited
97 Montreal Street | Sydenham
Christchurch

T: +64 (0) 800 121280
E: info@kingspanpanels.co.nz
www.kingspanpanels.co.nz

For the product offering in other markets please contact your local sales representative
or visit www.kingspanpanels.com

Care has been taken to ensure that the contents of this publication are accurate, but
Kingspan Limited and its subsidiary companies do not accept responsibility for errors
or for information that is found to be misleading. Suggestions for, or description of,
the end use or application of products or methods of working are for information only and
Kingspan Limited and its subsidiaries accept no liability in respect thereof.

02/2020

