

VERTICAL KARRIER™ PANEL - FLAT RAIL - METAL FACADE

FRKPV-DS-01-MTLH	C & I DISCLAIMER
FRKPV-PJ-01-MTLH	EXPANDED PANEL JOINT
FRKPV-PJ-02-MTLH	ENGAGED PANEL JOINT
FRKPV-PJ-03-MTLH	INTERMEDIATE SUPPORT
FRKPV-FS-01-MTLH	MULTI-STORY FIRE STOPPING DETAIL
FRKPV-FS-02-MTLH	MULTI-STORY FIRE STOPPING ASSEMBLY
FRKPV-BS-01-MTLH	BASE DETAIL FLUSH
FRKPV-BS-02-MTLH	BASE AT NOTCHED CONCRETE
FRKPV-BS-03-MTLH	BASE AT OVERHANG
FRKPV-BS-04-MTLH	BASE AT OVERHANG
FRKPV-OC-01-MTLH	OUTSIDE CORNER
FRKPV-IC-01-MTLH	INSIDE CORNER
FRKPV-FO-01-MTLH	FRAMED OPENING HEAD
FRKPV-FO-02-MTLH	FRAMED OPENING JAMB
FRKPV-FO-03-MTLH	FRAMED OPENING SILL
FRKPV-SJ-01-MTLH	STACK JOINT
FRKPV-PR-01-MTLH	PARAPET DETAIL
FRKPV-LE-01-MTLH	LOW EAVE DETAIL
FRKPV-RD-01-MTLH	RAKE DETAIL
FRKPV-TP-01-MTLH	PANEL TERMINATION
FRKPV-TL-01-MTLH	TRIM END LAP
FRKPV-TL-02-MTLH	TRIM END LAP WITH HEMS

INDEX SHEET

DETAIL #: FRKPV-XX-XX-MTLH

DATE: 2018



www.kingspanpanels.us
www.kingspanpanels.ca

VERTICAL KARRIER™ PANEL - FLAT RAIL - METAL FACADE

DISCLAIMERS:

THESE DETAILS ARE PROVIDED AS A GUIDELINE FOR PROPER PANEL AND ASSOCIATED COMPONENT INSTALLATION, AND ARE BASED ON INDUSTRY ACCEPTED PRACTICES.

LOCATION OF VAPOR BARRIERS AND ASSOCIATED SEALANTS IN THESE DETAILS ARE BASED ON TYPICAL DESIGN PRACTICES FOR MOST U.S. AND CANADIAN CLIMATIC ZONES. (THE PRIMARY VAPOR BARRIER IS PLACED ON THE "WARM" SIDE IN WINTER).

PROJECTS LOCATED IN AREAS SUBJECT TO EXTREME COLD AND/OR HIGH SNOW LOADS MAY REQUIRE MODIFICATIONS TO THESE DETAILS - CONTACT KINGSPAN TECHNICAL SERVICES FOR SPECIFIC PROJECT RECOMMENDATIONS.

ALL STRUCTURAL SUPPORTS ARE NOT BY KINGSPAN AND ARE SHOWN FOR CLARIFICATION AND ILLUSTRATION PURPOSES ONLY.

WALL SYSTEM DEFLECTIONS ARE TO BE DETERMINED BY THE ENGINEER OF RECORD.

ALL STRUCTURAL SUPPORTS ARE NOT BY KINGSPAN AND ARE SHOWN FOR CLARIFICATION AND ILLUSTRATION PURPOSES ONLY.

CONTACT KINGSPAN TECHNICAL SERVICES FOR MAXIMUM ALLOWABLE PANEL SPANS AND FASTENING PATTERNS.

DISCLAIMER

DETAIL #: FRKPV-DS-01-MTLH

DATE: 2018



www.kingspanpanels.us
www.kingspanpanels.ca

VERTICAL KARRIER™ PANEL - FLAT RAIL - METAL FACADE

CORE DEPTHS:
2", 2.5", 3", 4", 5", 6"

MODULE WIDTH: 24", 30", 36", 42"

EMBOSSING:

EXTERIOR: STUCCO / SMOOTH*

INTERIOR: STUCCO / SMOOTH

LENGTHS:

MINIMUM: 8'-0"

MAXIMUM: 53'-0"

STEEL GAUGES:

EXTERIOR: (REFER TO PROFILE)

INTERIOR: 26, 24, 22

REVEAL: $\frac{3}{8}$ "

KARRIER CONFIGURATION

REQUIRES $\frac{3}{8}$ " REVEAL

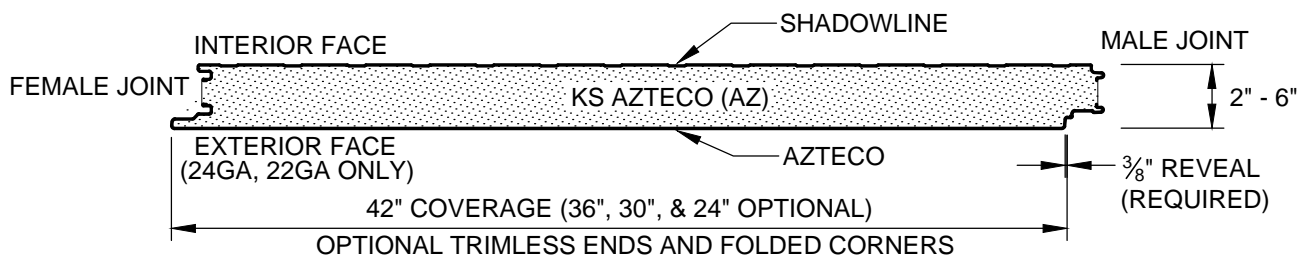
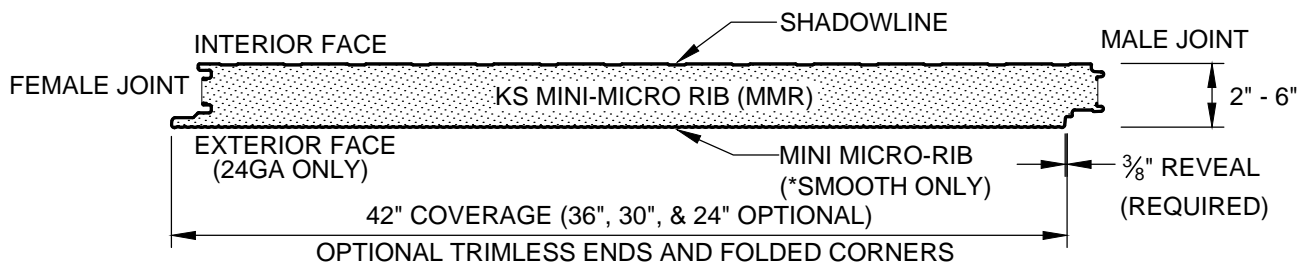
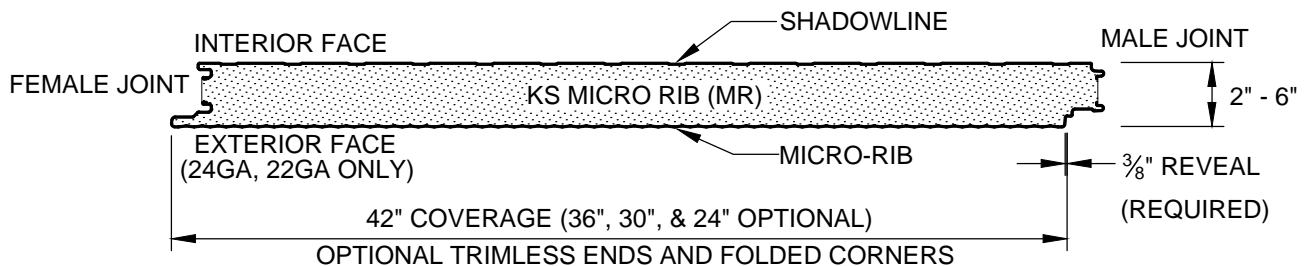
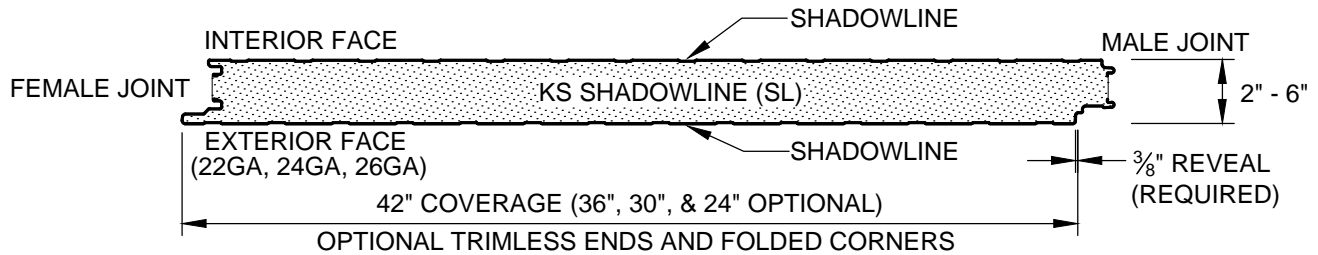

EXPANDED PANEL
JOINT

DETAIL #: FRKPV-PP-01-MTLH

DATE: 2018



www.kingspanpanels.us
www.kingspanpanels.ca

VERTICAL KARRIER™ PANEL - FLAT RAIL - METAL FACADE

CORE DEPTHS:
2", 2.5", 3", 4", 5", 6"

MODULE WIDTH: 24", 30", 36", 42"

PANEL ORIENTATION: VERTICAL

EMBOSSING:
EXTERIOR: STUCCO / SMOOTH*
INTERIOR: STUCCO / SMOOTH
LENGTHS:
MINIMUM: 8'-0"
MAXIMUM: 53'-0"

STEEL GAUGES:
EXTERIOR: (REFER TO PROFILE)
INTERIOR: 26, 24, 22

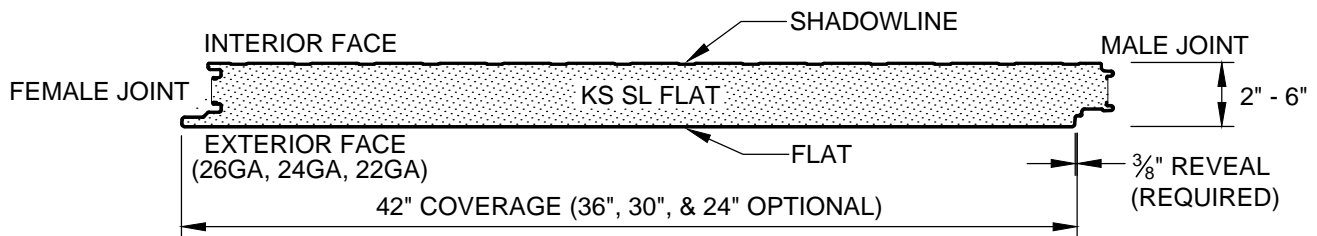
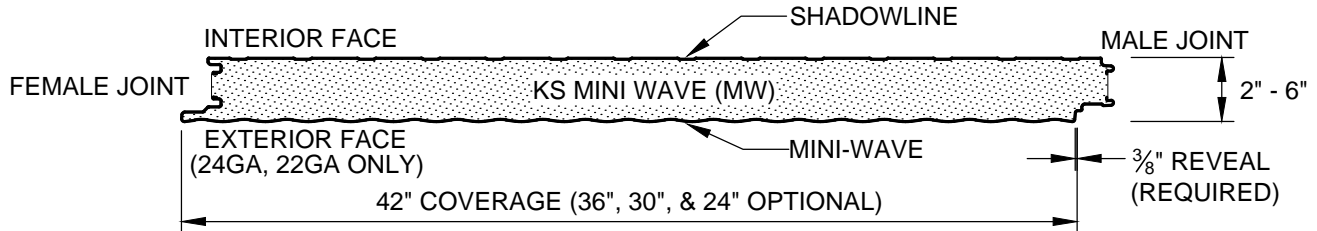

EXPANDED PANEL
JOINT

DETAIL #: FRKPV-PP-01-MTLH

DATE: 2018



www.kingspanpanels.us
www.kingspanpanels.ca

VERTICAL KARRIER™ PANEL - FLAT RAIL - METAL FACADE

NOTE:
FOR PROJECTS REQUIRING NFPA 285:
INTERIOR SIDE OF FRAMING MUST
HAVE $\frac{5}{8}$ " THICK FIRE BLOCK TYPE X
GYPSUM BOARD (NOT BY KINGSPAN)

(2) $\frac{1}{4}$ " - 14 HEX HEAD THROUGH
FASTENERS W/O WASHER AT
EACH SUPPORT
(FASTENER TYPE AND LENGTH
VARY DUE TO PANEL THICKNESS
AND SUB STRUCTURE TYPE)

$\frac{1}{4}$ " - 14 HEX HEAD THROUGH
FASTENERS W/ WASHER.
(FASTENER TYPE AND
LENGTH VARY DUE TO
PANEL THICKNESS AND SUB
STRUCTURE TYPE)

SET KARRIER™ RAIL IN
BUTYL SEALANT AT
FASTENER LOCATIONS

HORIZONTAL SUPPORT
(NOT BY KINGSPAN)

CONTINUOUS BUTYL
SEALANT, ENSURE THERE
ARE NO GAPS OR VOIDS OF
SEALANT IN JOINT

CONTINUOUS
BUTYL SEALANT
(OPTIONAL)

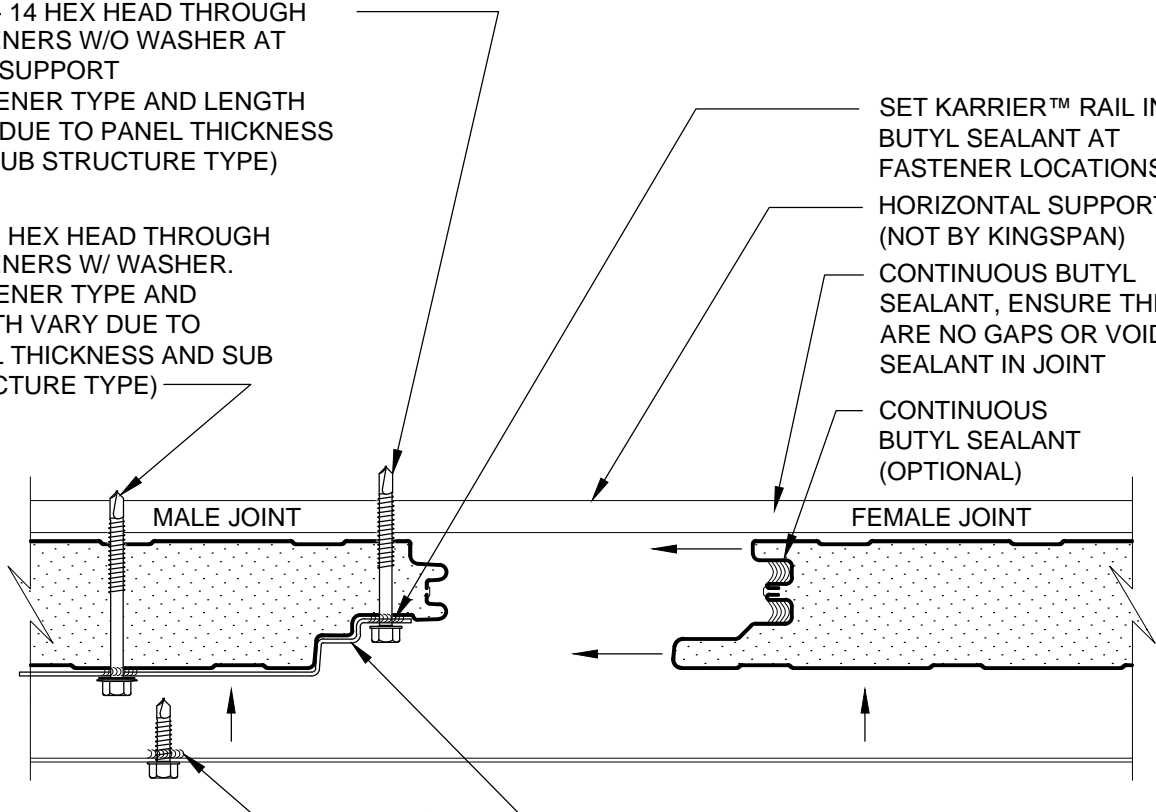

SET HAT CHANNEL IN BUTYL
SEALANT AT FASTENER
LOCATIONS

CONTINUOUS KARRIER™
FLAT RAIL

HORIZONTAL HAT CHANNEL
FASTENED AT EACH KARRIER
RAIL LOCATION. HAT CHANNEL
SPACING TO BE DETERMINED

FACADE PANEL AND FASTENING NOT SHOWN FOR CLARITY.
SEE NEXT DETAIL FOR FACADE FASTENING DETAILS

WALL PANEL INSTALLATION DIRECTION →

EXPANDED PANEL
JOINT

DETAIL #: FRKPV-PJ-01-MTLH

DATE: 2018



www.kingspanpanels.us
www.kingspanpanels.ca

VERTICAL KARRIER™ PANEL - FLAT RAIL - METAL FACADE

NOTE:

FOR PROJECTS REQUIRING NFPA 285:
INTERIOR SIDE OF FRAMING MUST
HAVE $\frac{5}{8}$ " THICK FIRE BLOCK TYPE X
GYPSUM BOARD (NOT BY KINGSPAN)

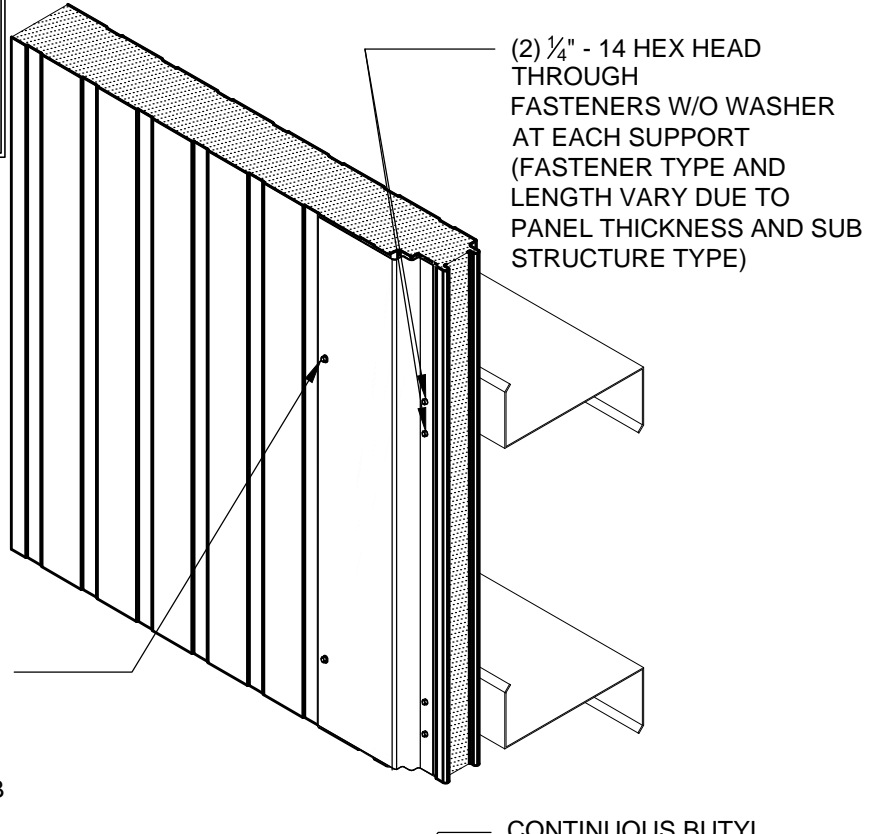

SET KARRIER™ RAIL IN BUTYL SEALANT AT FASTENER LOCATIONS

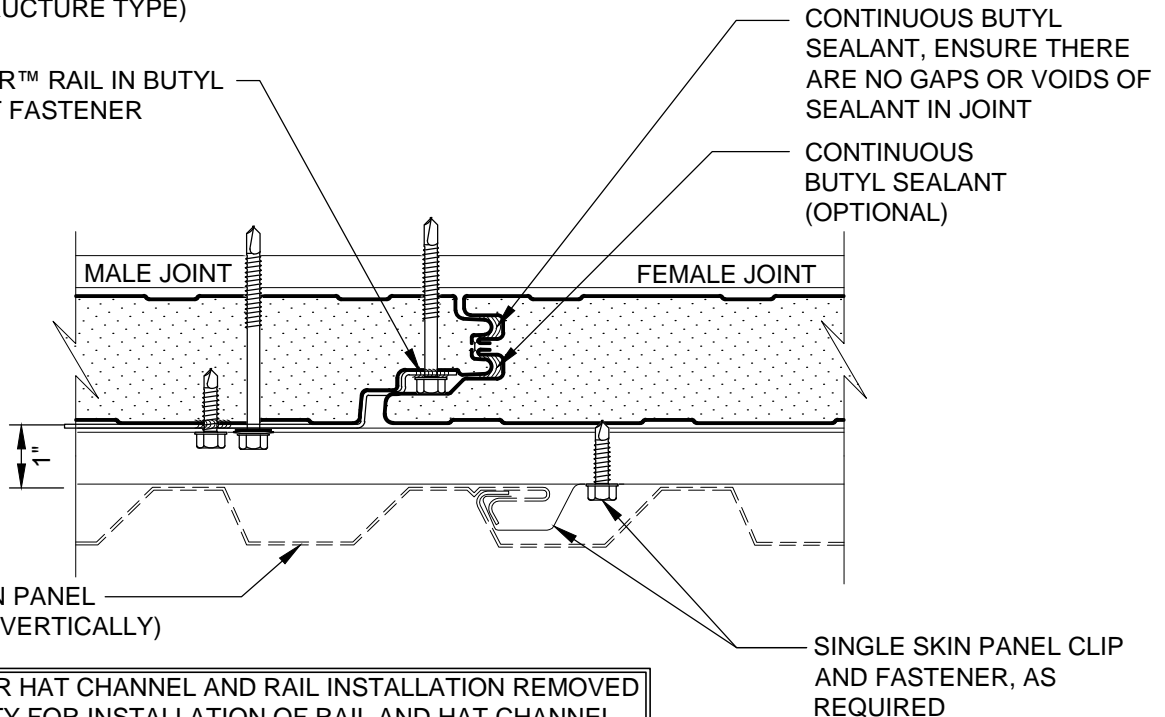

NOTING FOR HAT CHANNEL AND RAIL INSTALLATION REMOVED FOR CLARITY.FOR INSTALLATION OF RAIL AND HAT CHANNEL NOTES, SEE PREVIOUS DETAIL

WALL PANEL INSTALLATION DIRECTION →

ENGAGED PANEL
JOINT

DETAIL #: FRKPV-PJ-02-MTLH

DATE: 2018



www.kingspanpanels.us
www.kingspanpanels.ca

VERTICAL KARRIER™ PANEL - FLAT RAIL - METAL FACADE

NOTE:

FOR PROJECTS REQUIRING NFPA 285:
INTERIOR SIDE OF FRAMING MUST
HAVE $\frac{5}{8}$ " THICK FIRE BLOCK TYPE X
GYPSUM BOARD (NOT BY KINGSPAN)

$\frac{1}{4}$ " - 14 HEX HEAD THROUGH
FASTENERS W/ WASHER
(BEYOND) (FASTENER TYPE
AND LENGTH VARY DUE TO
PANEL THICKNESS AND SUB
STRUCTURE TYPE)

(2) $\frac{1}{4}$ " - 14 HEX HEAD THROUGH
FASTENERS W/O WASHER AT
EACH SUPPORT
(FASTENER TYPE AND LENGTH
VARY DUE TO PANEL THICKNESS
AND SUB STRUCTURE TYPE)

HORIZONTAL SUPPORT
(NOT BY KINGSPAN)

SET KARRIER™ RAIL IN BUTYL
SEALANT AT FASTENER
LOCATIONS

CONTINUOUS KARRIER™
FLAT RAIL

HORIZONTAL HAT CHANNEL
FASTENED AT EACH KARRIER
RAIL LOCATION. HAT CHANNEL
SPACING TO BE DETERMINED

SINGLE SKIN PANEL CLIP
AND FASTENER, AS
REQUIRED

SET HAT CHANNEL IN BUTYL
SEALANT AT FASTENER
LOCATIONS

SINGLE SKIN PANEL
(INSTALLED VERTICALLY)

PANEL
THICKNESS 1"

NOTE:

CONTACT KINGSPAN TECHNICAL SERVICES FOR SPECIFIC PROJECT RECOMMENDATIONS

INTERMEDIATE
SUPPORT

DETAIL #: FRKPV-PJ-03-MTLH

DATE: 2018



www.kingspanpanels.us
www.kingspanpanels.ca

VERTICAL KARRIER™ PANEL - FLAT RAIL - METAL FACADE

NOTE:
FOR PROJECTS REQUIRING NFPA 285:
INTERIOR SIDE OF FRAMING MUST
HAVE $\frac{5}{8}$ " THICK FIRE BLOCK TYPE X
GYPSUM BOARD (NOT BY KINGSPAN)

NOTE:
FASTENING AND OTHER MATERIALS
NOT SHOWN FOR CLARITY OF
DETAIL

FLOOR SLAB, FRAMING
AND OTHER MATERIALS
(NOT BY KINGSPAN)

COMPLETELY FILL VOID BETWEEN
INSULATED METAL PANEL SYSTEM
AND FACADE WITH MIN 4PSI
CONTINUOUS FIRE BLOCKING AT
EACH FLOOR LINE
(NOT BY KINGSPAN)

KARRIER PANEL
INSTALLED
VERTICALLY

FACADE PANEL
(INSTALLED
VERTICALLY)

F.F.

8" MIN

INSULATION WASHER
AND FASTENERS @
12" O.C.
(NOT BY KINGSPAN)

VOID

MULTI-STORY FIRE
STOPPING DETAIL

DETAIL #: FRKPV-FS-01-MTLH

DATE: 2018

Kingspan
Insulated Panels

www.kingspanpanels.us
www.kingspanpanels.ca

VERTICAL KARRIER™ PANEL - FLAT RAIL - METAL FACADE

NOTE:
FOR PROJECTS REQUIRING NFPA 285:
INTERIOR SIDE OF FRAMING MUST
HAVE $\frac{5}{8}$ " THICK FIRE BLOCK TYPE X
GYPSUM BOARD (NOT BY KINGSPAN)

KARRIER PANEL AND RAIL
INSTALLED VERTICALLY

NOTE:
FASTENING AND OTHER
MATERIALS NOT SHOWN FOR
CLARITY OF DETAIL

FLOOR SLAB, FRAMING
AND OTHER MATERIALS
(NOT BY KINGSPAN)

HORIZONTAL HAT CHANNEL
FASTENED AT EACH KARRIER
RAIL LOCATION. HAT CHANNEL
SPACING TO BE DETERMINED

KARRIER FLAT
RAIL

FACADE PANEL
(INSTALLED
VERTICALLY)

COMPLETELY FILL VOID
BETWEEN INSULATED
METAL PANEL SYSTEM AND
FACADE WITH MIN. 4 PSI
CONTINUOUS FIRE
BLOCKING AT EACH FLOOR
LINE
(NOT BY KINGSPAN)

INSULATION WASHER AND
FASTENERS @ 12" O.C.
(NOT BY KINGSPAN)

MULTI-STORY FIRE
STOPPING ASSEMBLY

DETAIL #: FRKPV-FS-02-MTLH

DATE: 2018



Kingspan
Insulated Panels

www.kingspanpanels.us
www.kingspanpanels.ca

VERTICAL KARRIER™ PANEL - FLAT RAIL - METAL FACADE

NOTE:

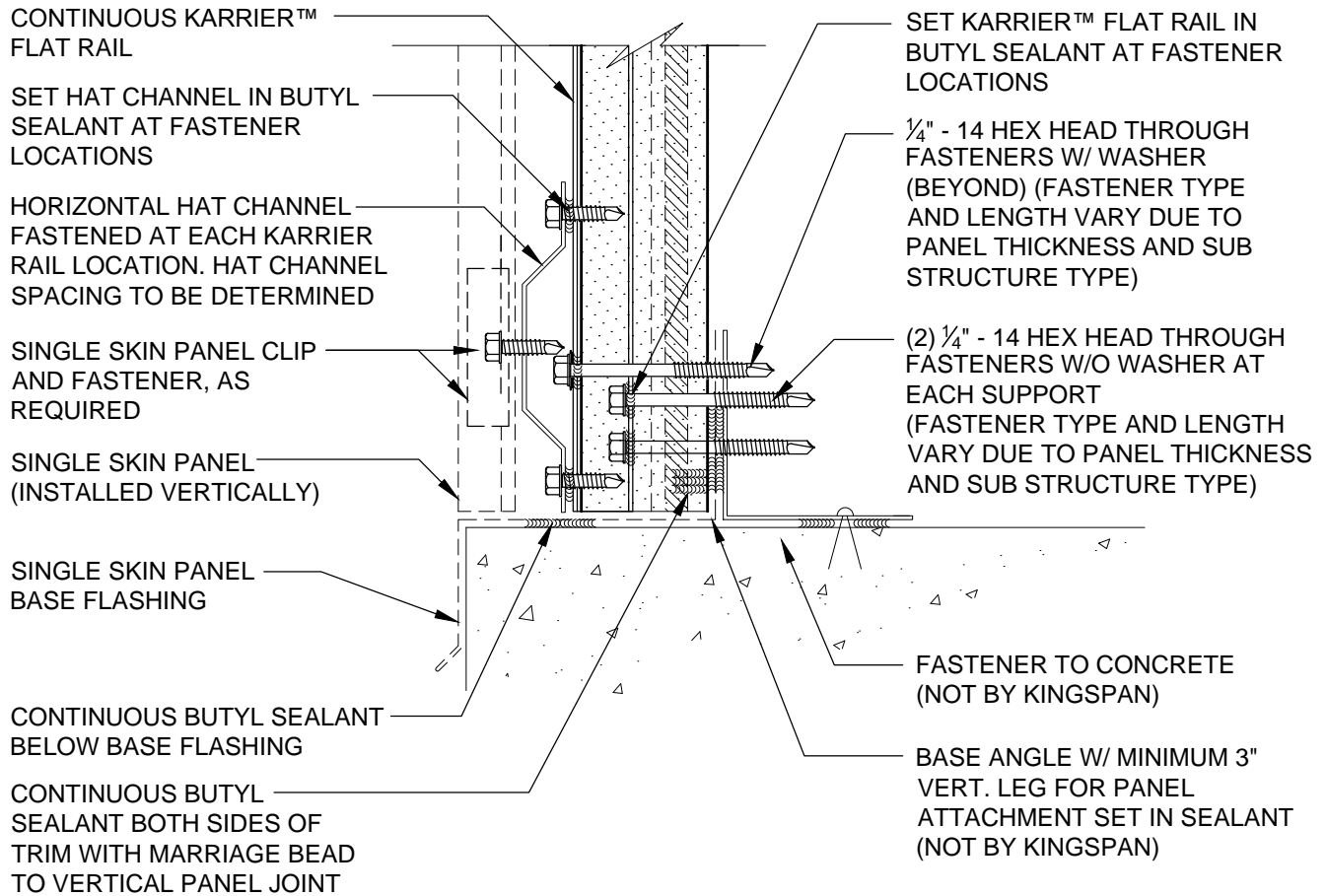
FOR PROJECTS REQUIRING NFPA 285:
INTERIOR SIDE OF FRAMING MUST
HAVE $\frac{5}{8}$ " THICK FIRE BLOCK TYPE X
GYPSUM BOARD (NOT BY KINGSPAN)



BASE DETAIL
FLUSH

DETAIL #: KPH-BS-01-MTLV

DATE: 2018



www.kingspanpanels.us
www.kingspanpanels.ca

VERTICAL KARRIER™ PANEL - FLAT RAIL - METAL FACADE

NOTE:

FOR PROJECTS REQUIRING NFPA 285:
INTERIOR SIDE OF FRAMING MUST
HAVE $\frac{5}{8}$ " THICK FIRE BLOCK TYPE X
GYPSUM BOARD (NOT BY KINGSPAN)

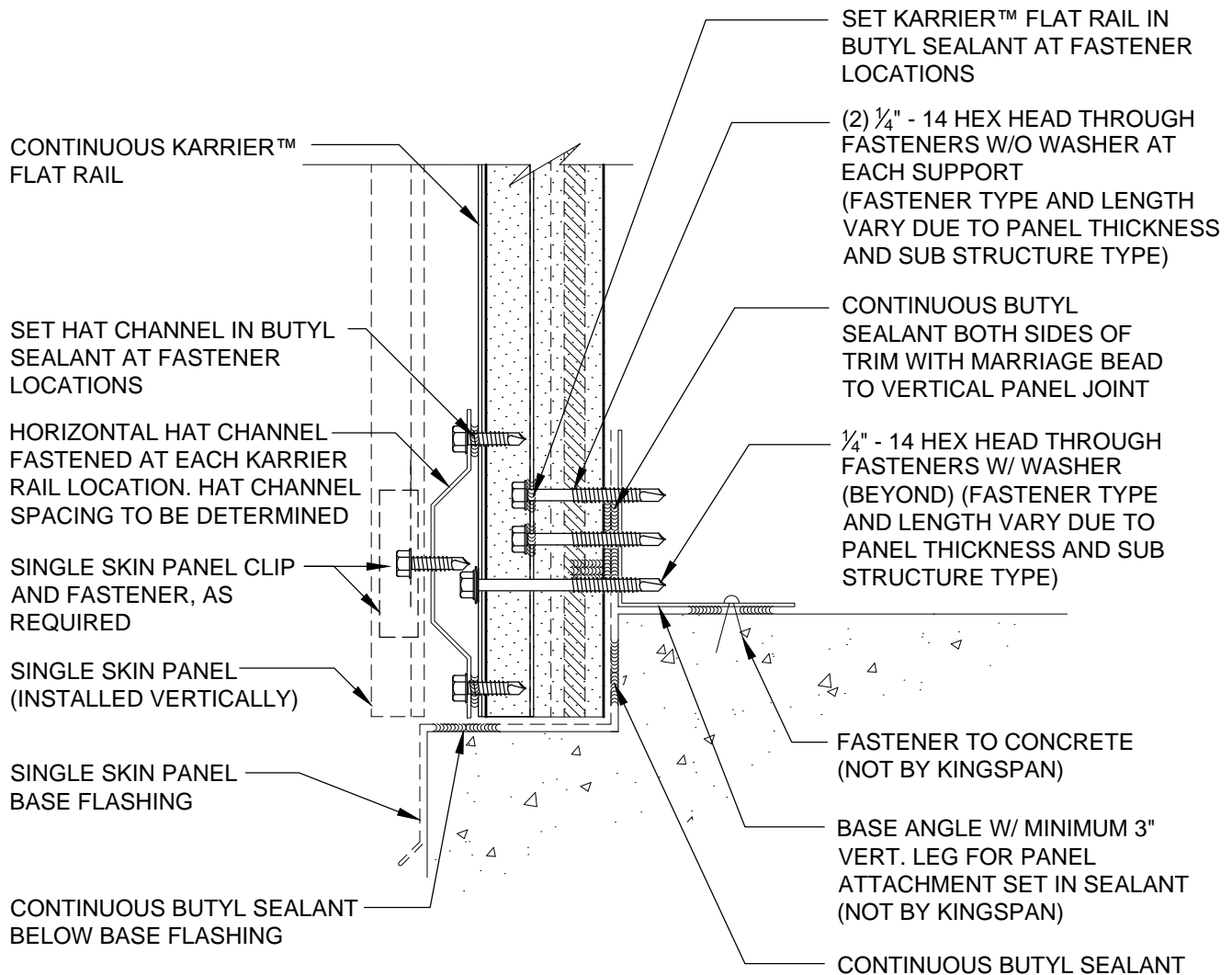

BASE AT NOTCHED
CONCRETE

DETAIL #: FRKPV-BS-02-MTLH

DATE: 2018



www.kingspanpanels.us
www.kingspanpanels.ca

VERTICAL KARRIER™ PANEL - FLAT RAIL - METAL FACADE

NOTE:

FOR PROJECTS REQUIRING NFPA 285:
INTERIOR SIDE OF FRAMING MUST
HAVE $\frac{5}{8}$ " THICK FIRE BLOCK TYPE X
GYPSUM BOARD (NOT BY KINGSPAN)

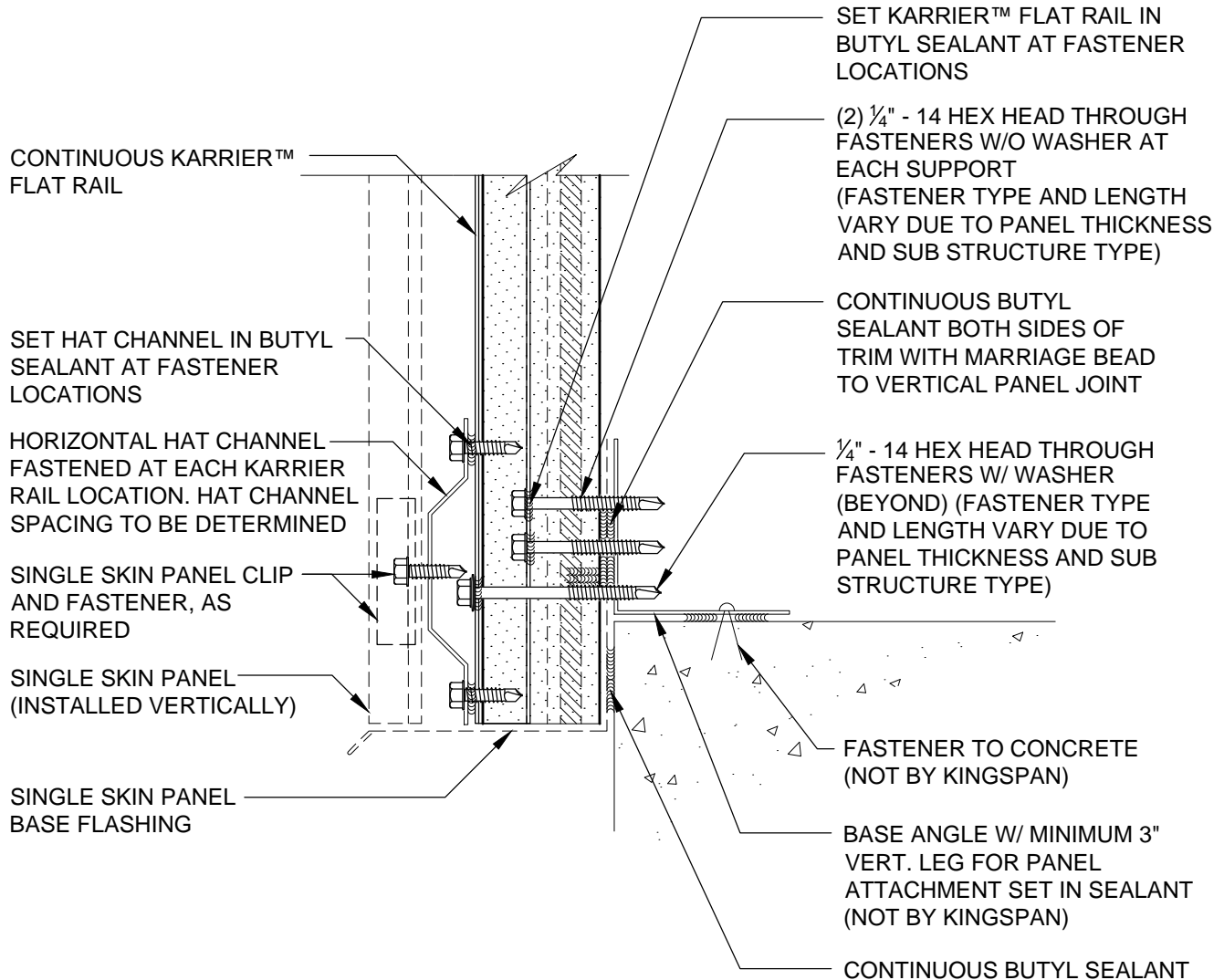

BASE AT OVERHANG

DETAIL #: FRKPV-BS-03-MTLH

DATE: 2018



www.kingspanpanels.us
www.kingspanpanels.ca

VERTICAL KARRIER™ PANEL - FLAT RAIL - METAL FACADE

NOTE:

FOR PROJECTS REQUIRING NFPA 285:
INTERIOR SIDE OF FRAMING MUST
HAVE $\frac{5}{8}$ " THICK FIRE BLOCK TYPE X
GYPSUM BOARD (NOT BY KINGSPAN)

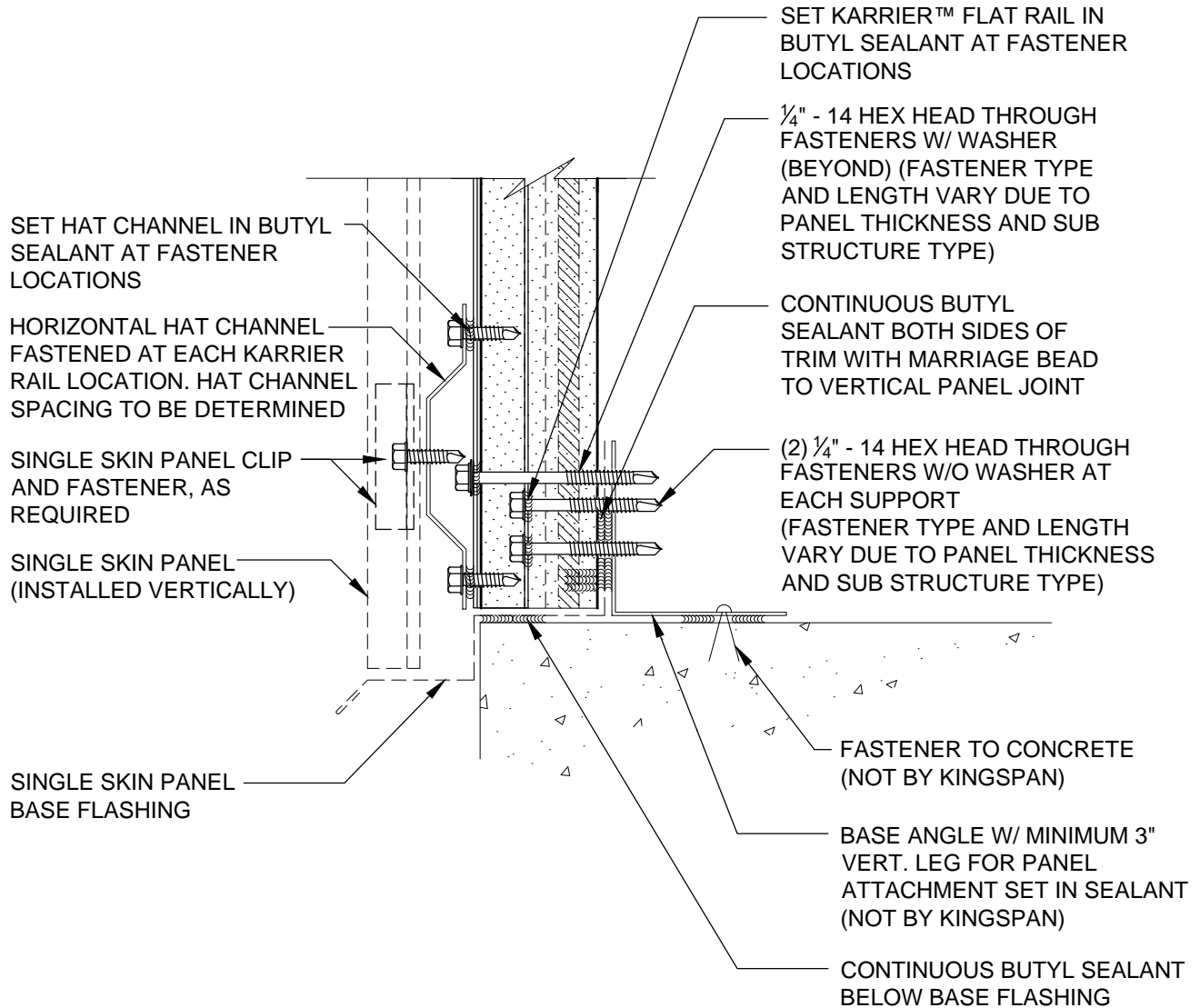

BASE AT OVERHANG

DETAIL #: FRKPV-BS-04-MTLH

DATE: 2018



www.kingspanpanels.us
www.kingspanpanels.ca

VERTICAL KARRIER™ PANEL - FLAT RAIL - METAL FACADE

NOTE:
FOR PROJECTS REQUIRING NFPA 285:
INTERIOR SIDE OF FRAMING MUST
HAVE 5/8" THICK FIRE BLOCK TYPE X
GYPSUM BOARD (NOT BY KINGSPAN)

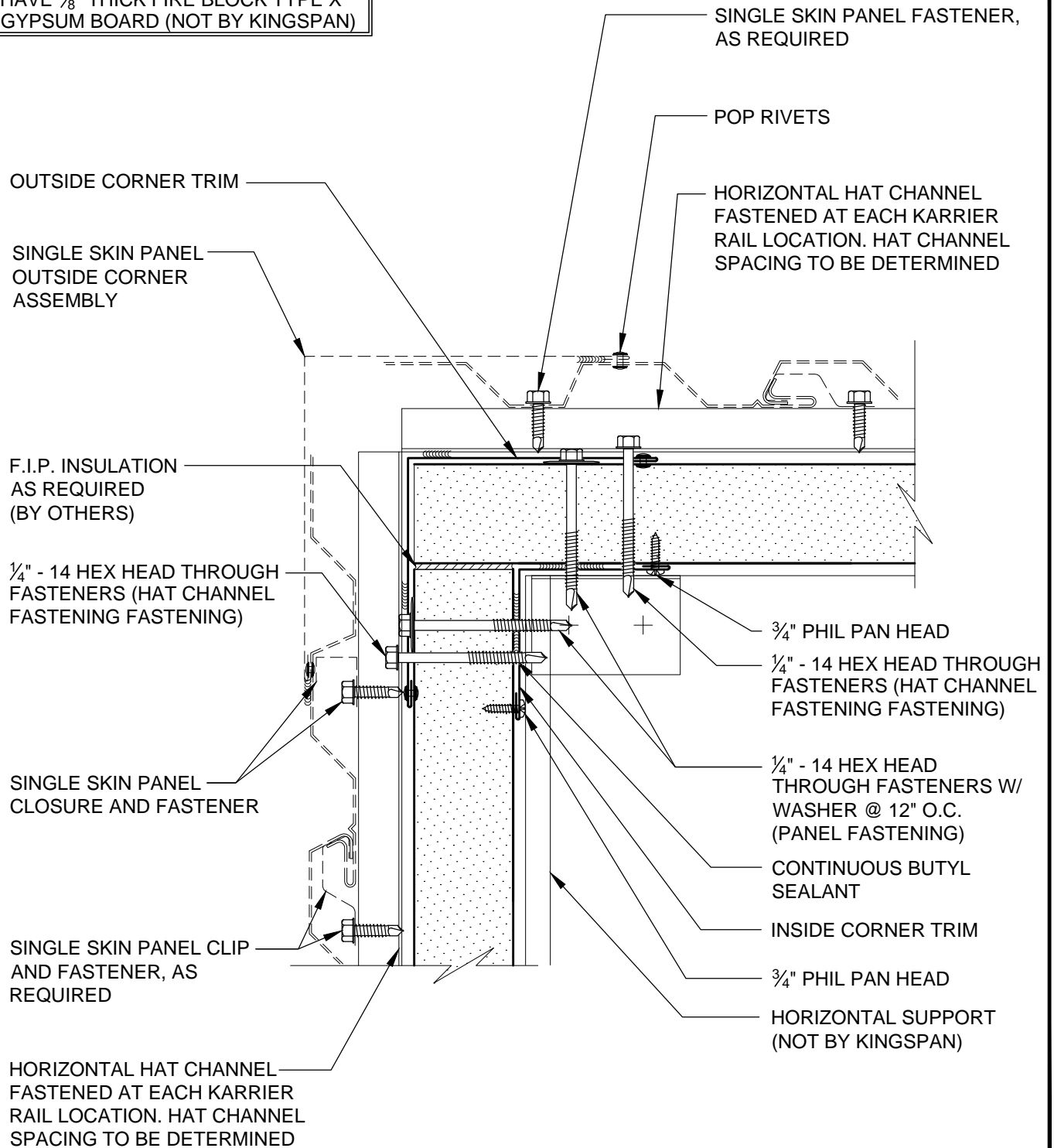

OUTSIDE CORNER

DETAIL #: FRKPV-OC-01-MTLH

DATE: 2018



www.kingspanpanels.us
www.kingspanpanels.ca

VERTICAL KARRIER™ PANEL - FLAT RAIL - METAL FACADE

NOTE:

FOR PROJECTS REQUIRING NFPA 285:
INTERIOR SIDE OF FRAMING MUST
HAVE $\frac{5}{8}$ " THICK FIRE BLOCK TYPE X
GYPSUM BOARD (NOT BY KINGSPAN)

$\frac{1}{4}$ " - 14 HEX HEAD THROUGH
FASTENERS W/ WASHER (BEYOND)
(FASTENER TYPE AND LENGTH VARY
DUE TO PANEL THICKNESS AND SUB
STRUCTURE TYPE)

CONTINUOUS BUTYL
SEALANT

INSIDE CORNER TRIM

F.I.P. INSULATION
AS REQUIRED
(BY OTHERS)

CONTINUOUS BUTYL
SEALANT

$\frac{1}{4}$ " - 14 HEX HEAD THROUGH
FASTENERS W/ WASHER @
12" O.C. (PANEL FASTENERS)

$\frac{3}{4}$ " PHIL PAN HEAD

$\frac{1}{4}$ " - 14 HEX HEAD THROUGH
FASTENERS (HAT CHANNEL
FASTENERS)

HORIZONTAL SUPPORT
(NOT BY KINGSPAN)

$\frac{3}{4}$ " PHIL PAN HEAD

SINGLE SKIN PANEL
CLOSURE AND FASTENER

SINGLE SKIN PANEL CORNER
ASSEMBLY

SINGLE SKIN PANEL FASTENER,
AS REQUIRED

POP RIVETS

OUTSIDE CORNER TRIM W/
POP RIVETS @ 12" O.C.

HORIZONTAL HAT CHANNEL
FASTENED AT EACH KARRIER
RAIL LOCATION. HAT CHANNEL
SPACING TO BE DETERMINED

INSIDE CORNER

DETAIL #: FRKPV-IC-01-MTLH

DATE: 2018

Kingspan
Insulated Panels

www.kingspanpanels.us
www.kingspanpanels.ca

VERTICAL KARRIER™ PANEL - FLAT RAIL - METAL FACADE

NOTE:

FOR PROJECTS REQUIRING NFPA 285:
INTERIOR SIDE OF FRAMING MUST
HAVE $\frac{5}{8}$ " THICK FIRE BLOCK TYPE X
GYPSUM BOARD (NOT BY KINGSPAN)

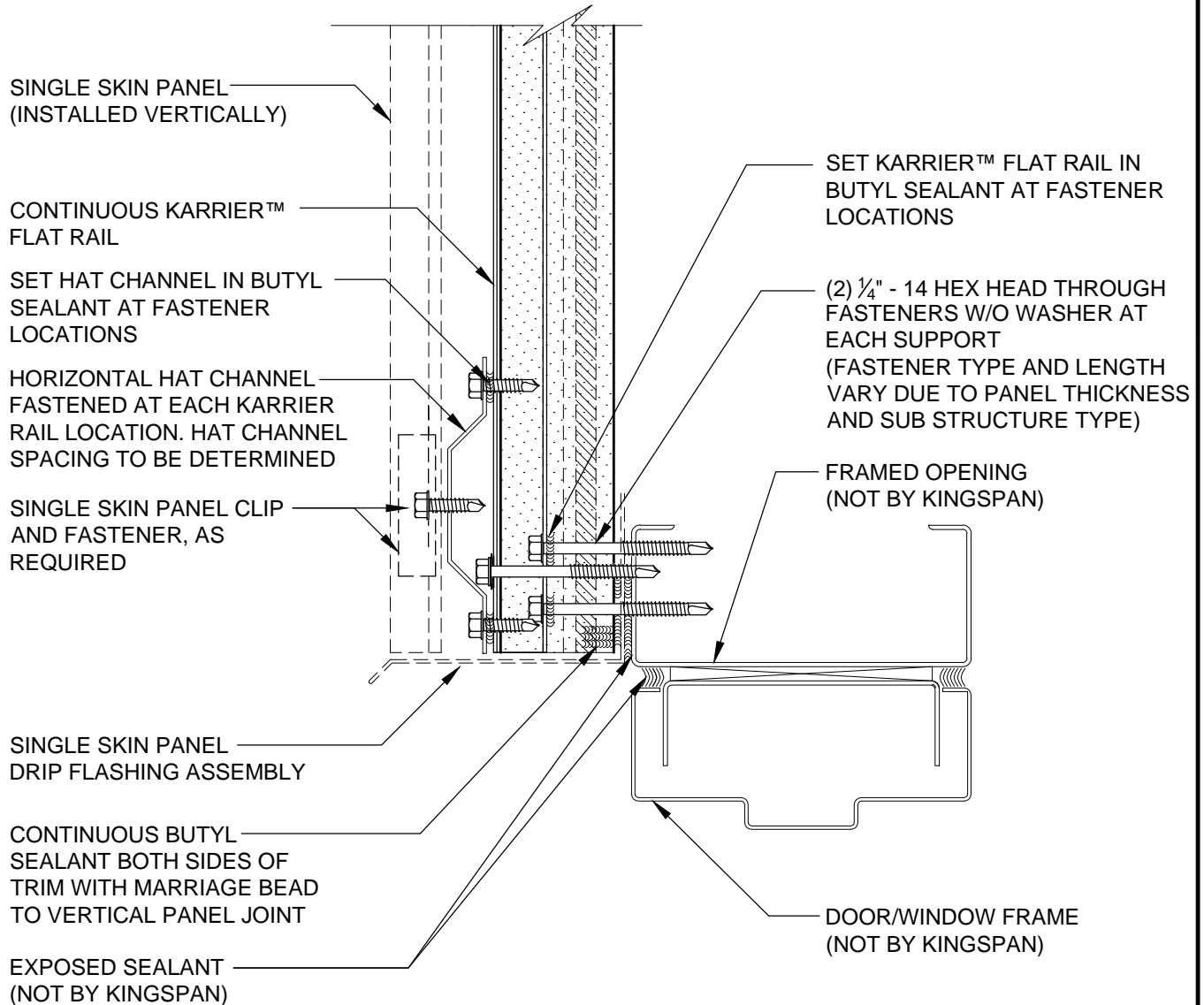

FRAMED OPENING HEAD

DETAIL #: FRKPV-FO-01-MTLH

DATE: 2018



www.kingspanpanels.us
www.kingspanpanels.ca

VERTICAL KARRIER™ PANEL - FLAT RAIL - METAL FACADE

NOTE:
FOR PROJECTS REQUIRING NFPA 285:
INTERIOR SIDE OF FRAMING MUST
HAVE $\frac{5}{8}$ " THICK FIRE BLOCK TYPE X
GYPSUM BOARD (NOT BY KINGSPAN)

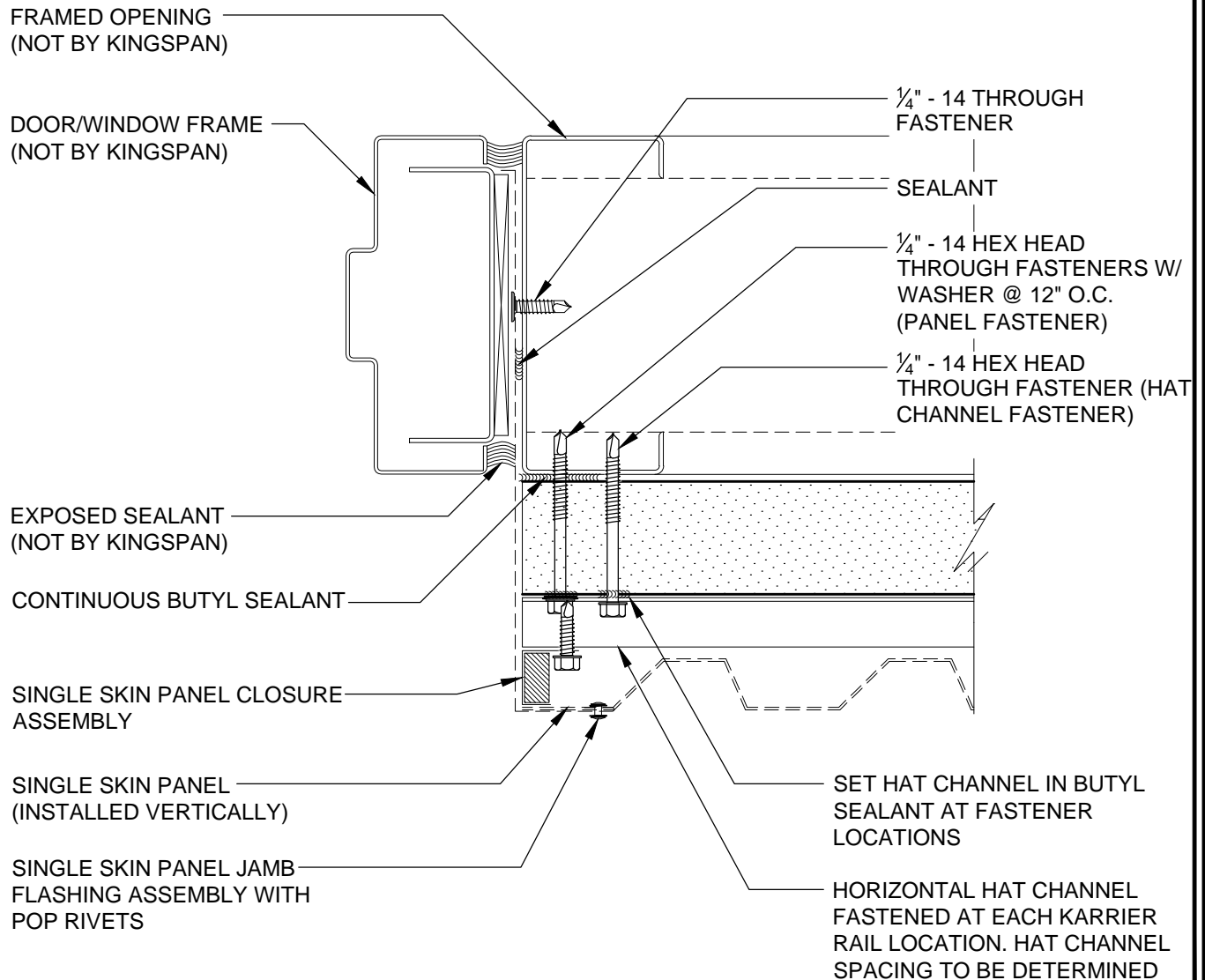

FRAMED OPENING
JAMB

DETAIL #: FRKPV-FO-02-MTLH

DATE: 2018



www.kingspanpanels.us
www.kingspanpanels.ca

VERTICAL KARRIER™ PANEL - FLAT RAIL - METAL FACADE

NOTE:

FOR PROJECTS REQUIRING NFPA 285:
INTERIOR SIDE OF FRAMING MUST
HAVE $\frac{5}{8}$ " THICK FIRE BLOCK TYPE X
GYPSUM BOARD (NOT BY KINGSPAN)

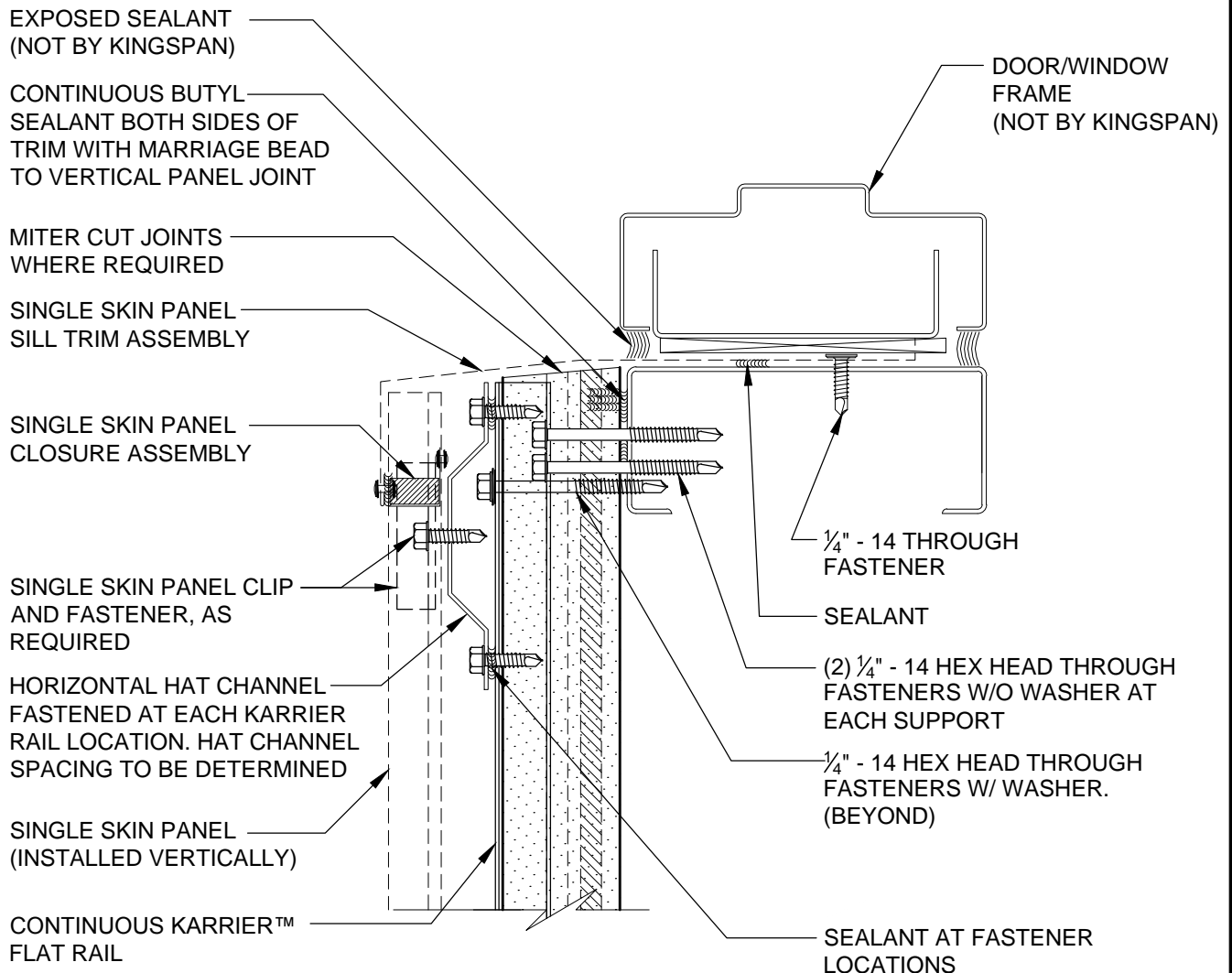

FRAMED OPENING SILL

DETAIL #: FRKPV-FO-03-MTLH

DATE: 2018



www.kingspanpanels.us
www.kingspanpanels.ca

VERTICAL KARRIER™ PANEL - FLAT RAIL - METAL FACADE

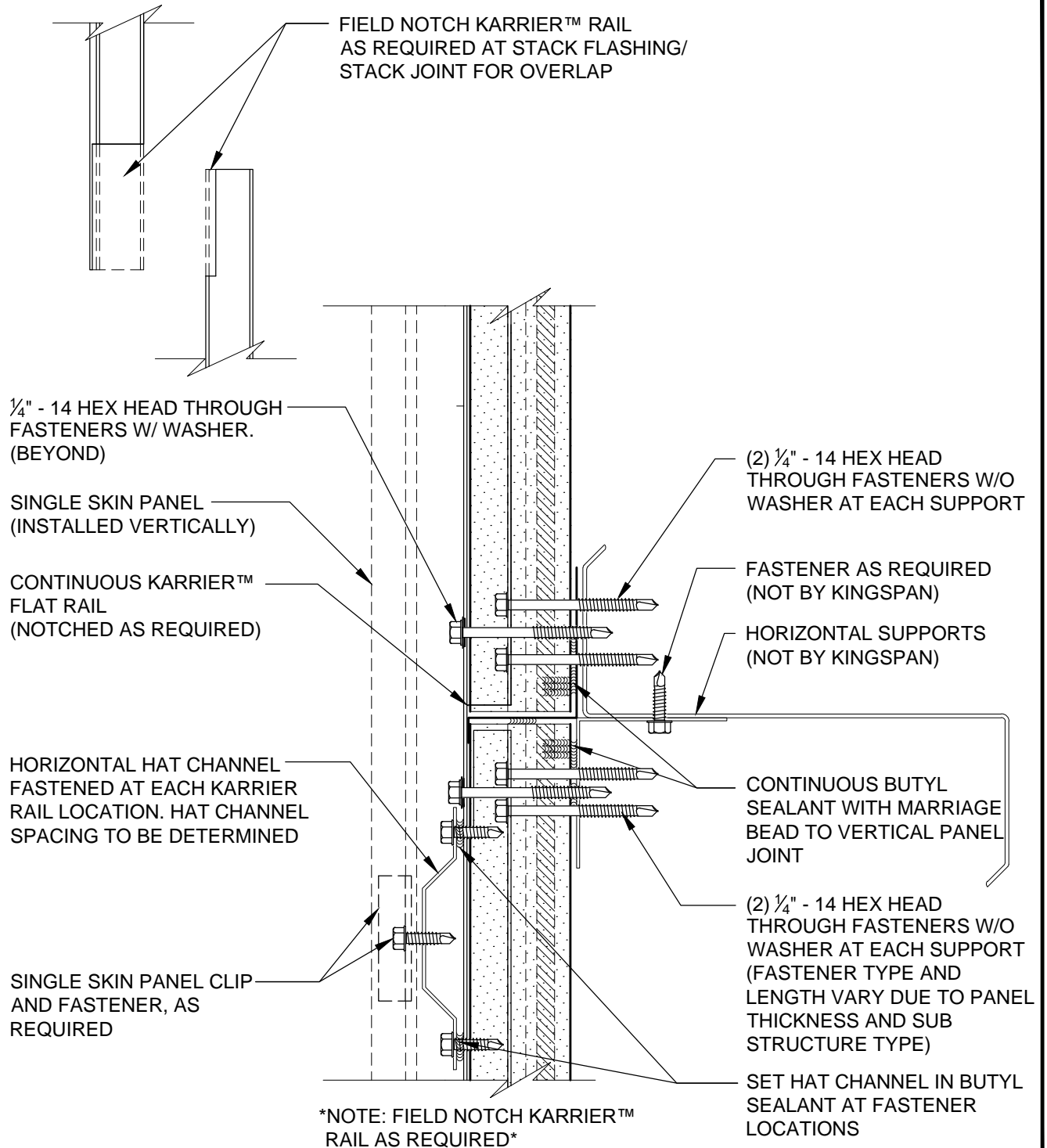

NOTE:
FOR PROJECTS REQUIRING NFPA 285:
INTERIOR SIDE OF FRAMING MUST
HAVE 5/8" THICK FIRE BLOCK TYPE X
GYPSUM BOARD (NOT BY KINGSPAN)

STACK JOINT

DETAIL #: FRKPV-SJ-01-MTLH

DATE: 2018



Kingspan®
Insulated Panels

www.kingspanpanels.us
www.kingspanpanels.ca

VERTICAL KARRIER™ PANEL - FLAT RAIL - METAL FACADE

NOTE:

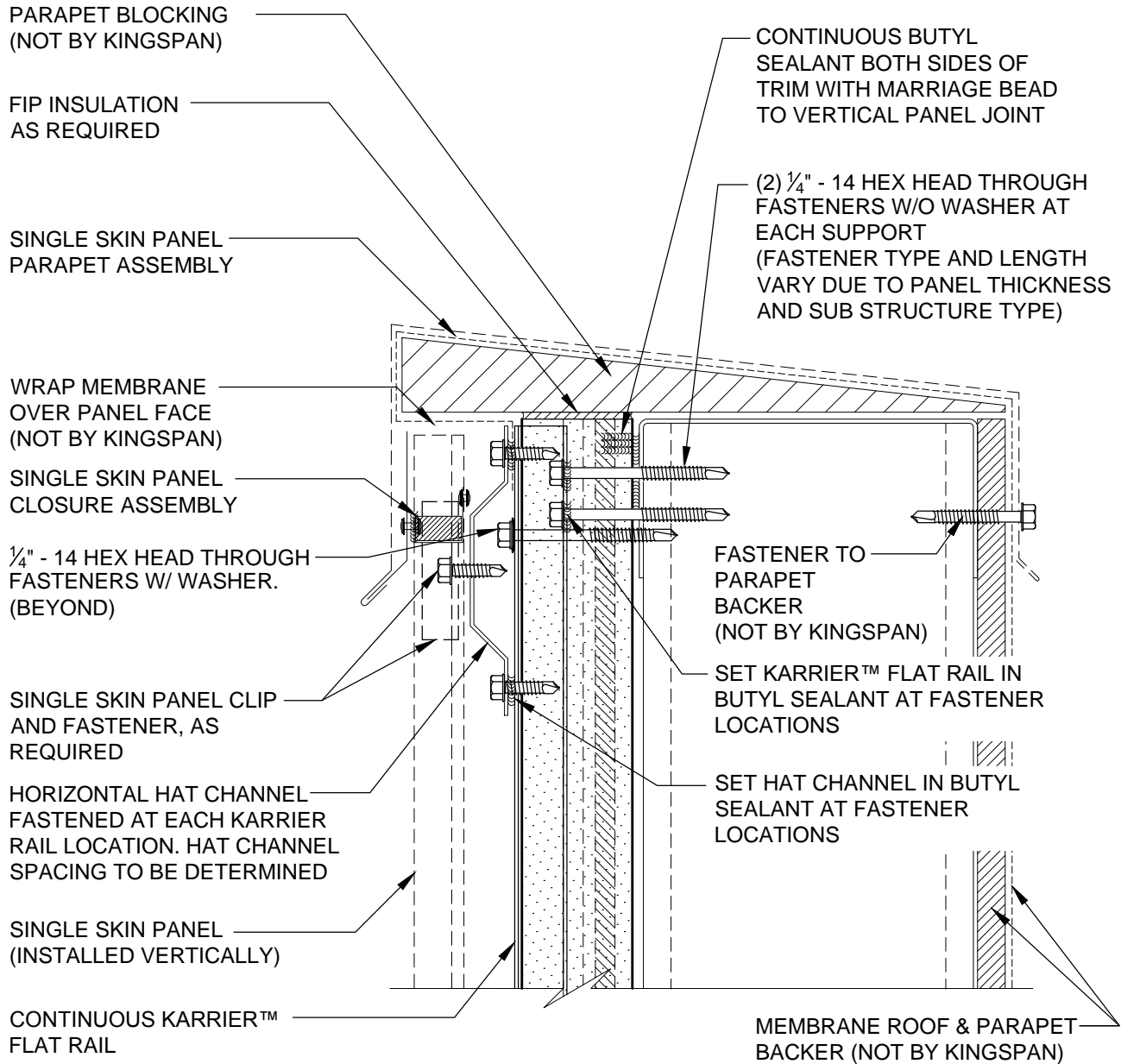
FOR PROJECTS REQUIRING NFPA 285:
INTERIOR SIDE OF FRAMING MUST
HAVE $\frac{5}{8}$ " THICK FIRE BLOCK TYPE X
GYPSUM BOARD (NOT BY KINGSPAN)



PARAPET DETAIL

DETAIL #: FRKPV-PR-01-MTLH

DATE: 2018



www.kingspanpanels.us
www.kingspanpanels.ca

VERTICAL KARRIER™ PANEL - FLAT RAIL - METAL FACADE

NOTE:

FOR PROJECTS REQUIRING NFPA 285:
INTERIOR SIDE OF FRAMING MUST
HAVE $\frac{5}{8}$ " THICK FIRE BLOCK TYPE X
GYPSUM BOARD (NOT BY KINGSPAN)

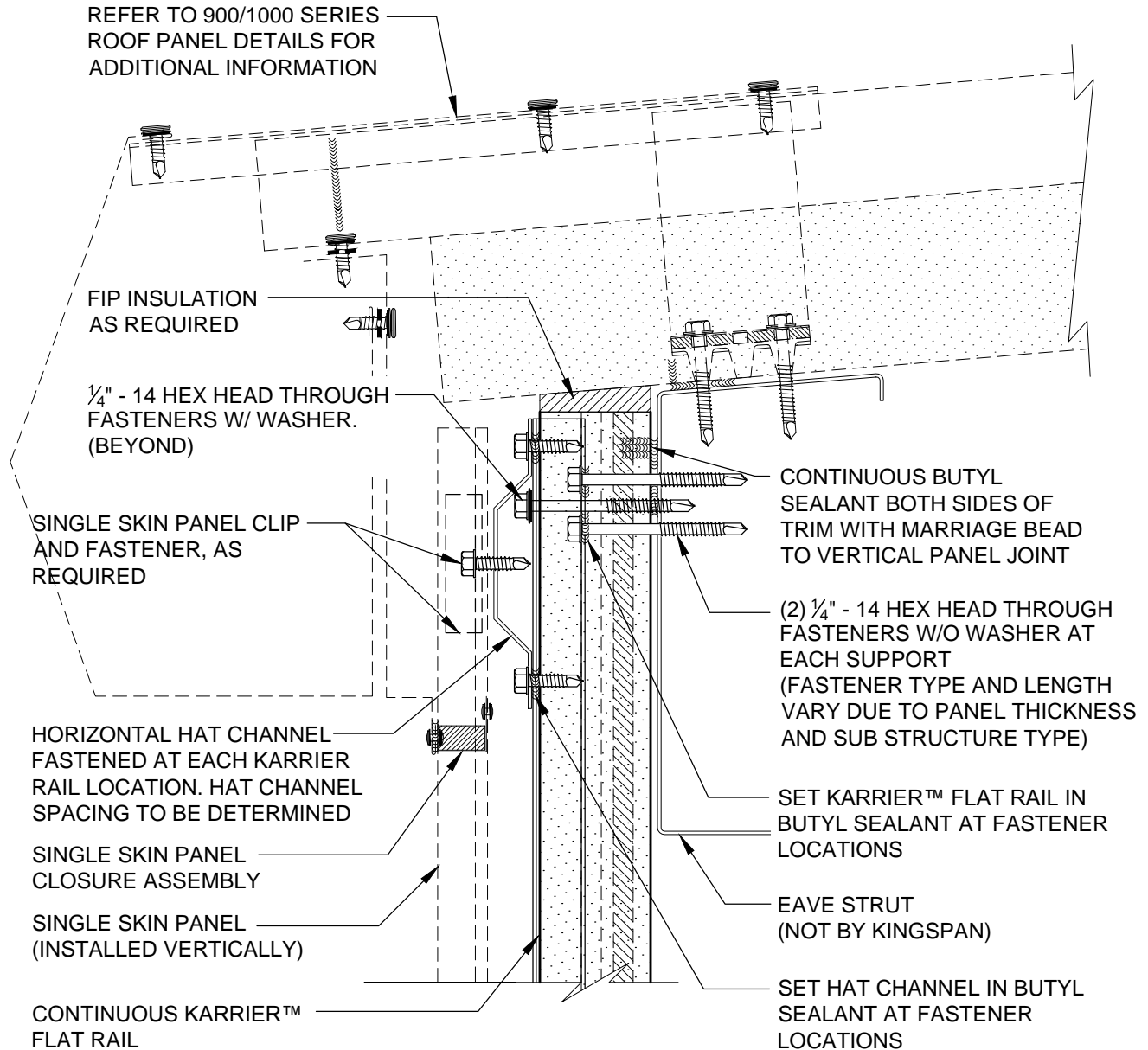

LOW EAVE DETAIL

DETAIL #: FRKPV-LE-01-MTLH

DATE: 2018



www.kingspanpanels.us
www.kingspanpanels.ca

VERTICAL KARRIER™ PANEL - FLAT RAIL - METAL FACADE

NOTE:

FOR PROJECTS REQUIRING NFPA 285:
INTERIOR SIDE OF FRAMING MUST
HAVE $\frac{5}{8}$ " THICK FIRE BLOCK TYPE X
GYPSUM BOARD (NOT BY KINGSPAN)

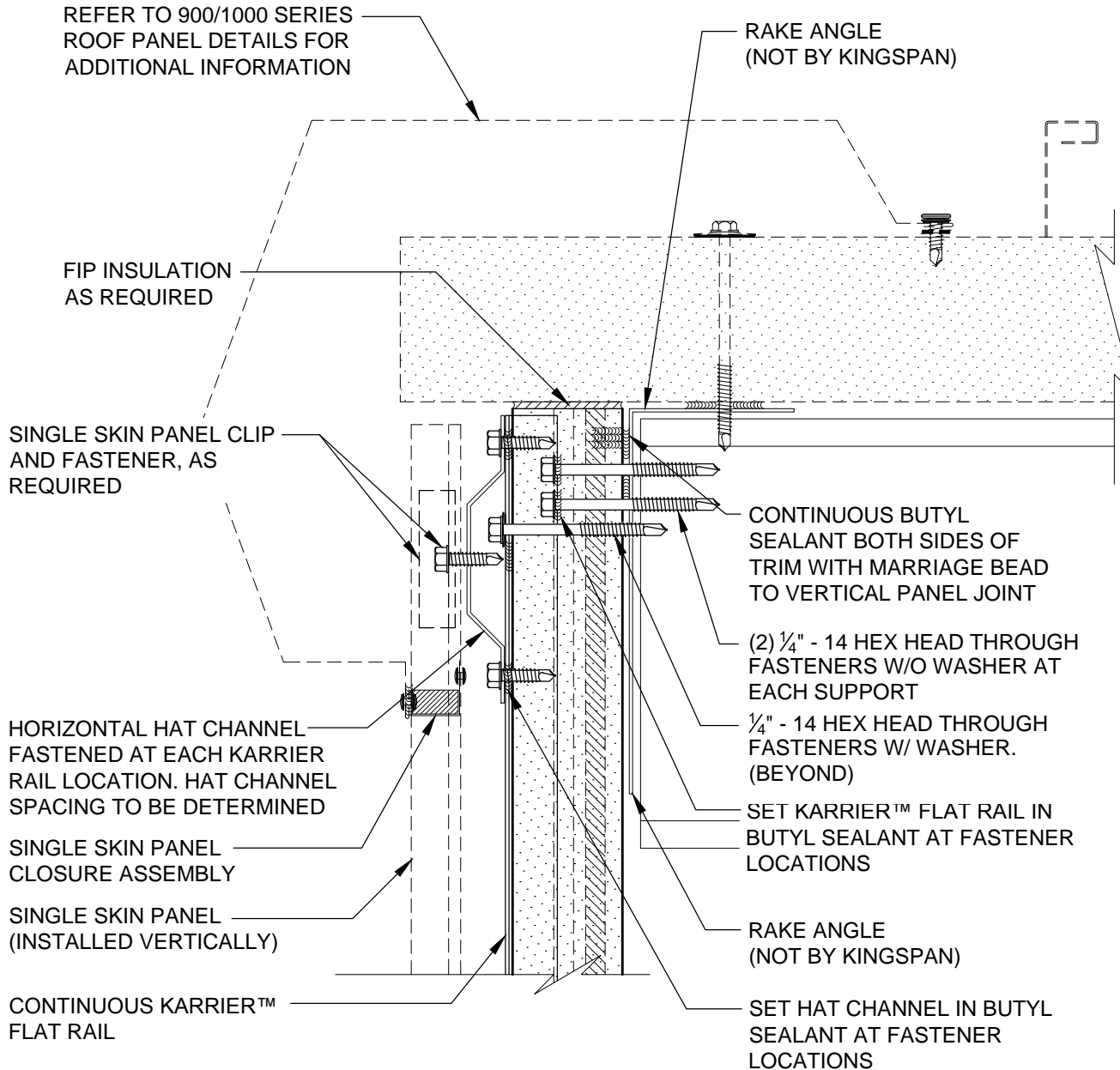

RAKE DETAIL

DETAIL #: FRKPV-RD-01-MTLH

DATE: 2018



www.kingspanpanels.us
www.kingspanpanels.ca

VERTICAL KARRIER™ PANEL - FLAT RAIL - METAL FACADE

NOTE:

FOR PROJECTS REQUIRING NFPA 285:
INTERIOR SIDE OF FRAMING MUST
HAVE $\frac{5}{8}$ " THICK FIRE BLOCK TYPE X
GYPSUM BOARD (NOT BY KINGSPAN)

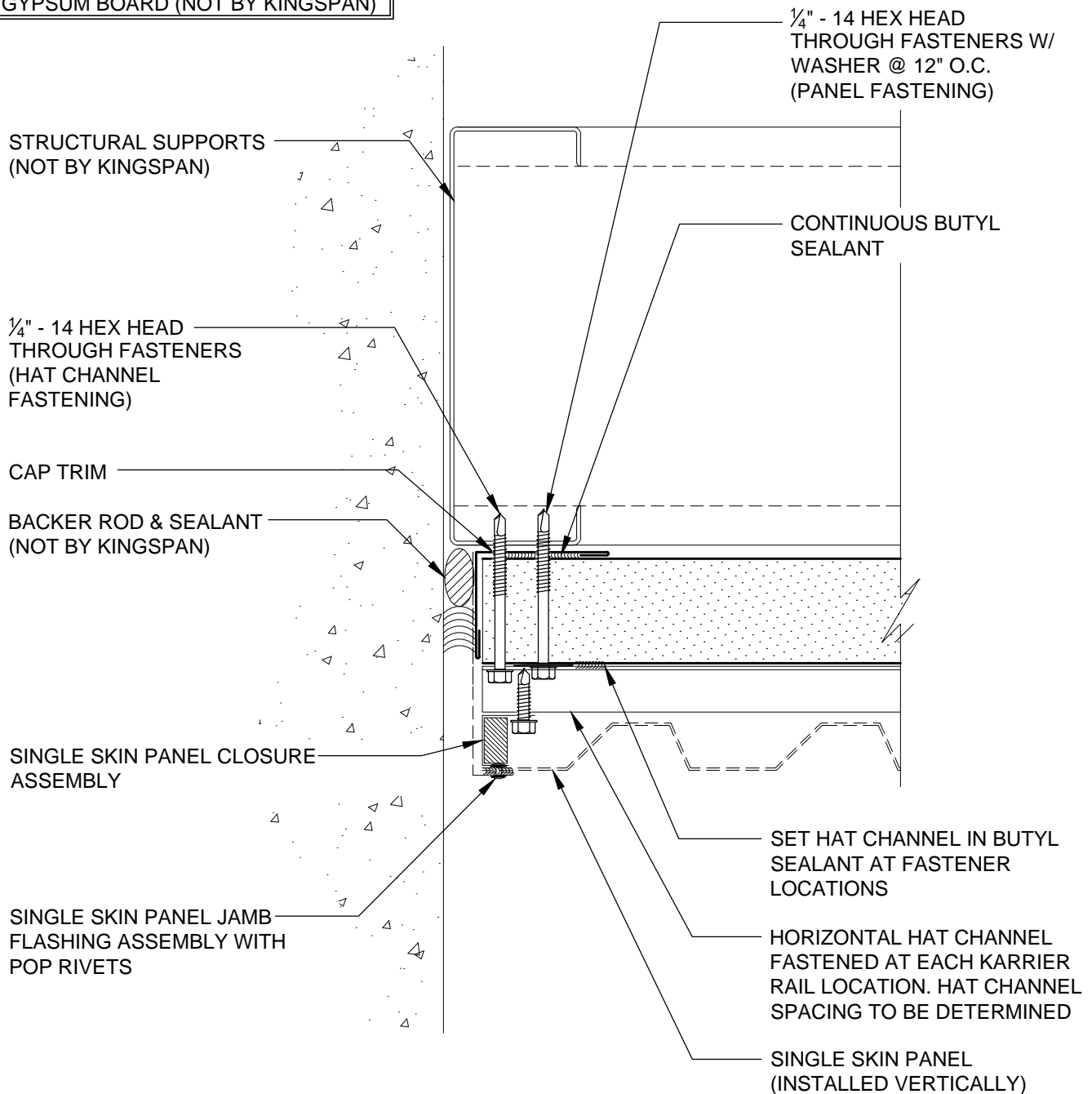

PANEL TERMINATION

DETAIL #: FRKPV-TP-01-MTLH

DATE: 2018



www.kingspanpanels.us
www.kingspanpanels.ca

VERTICAL KARRIER™ PANEL - FLAT RAIL - METAL FACADE

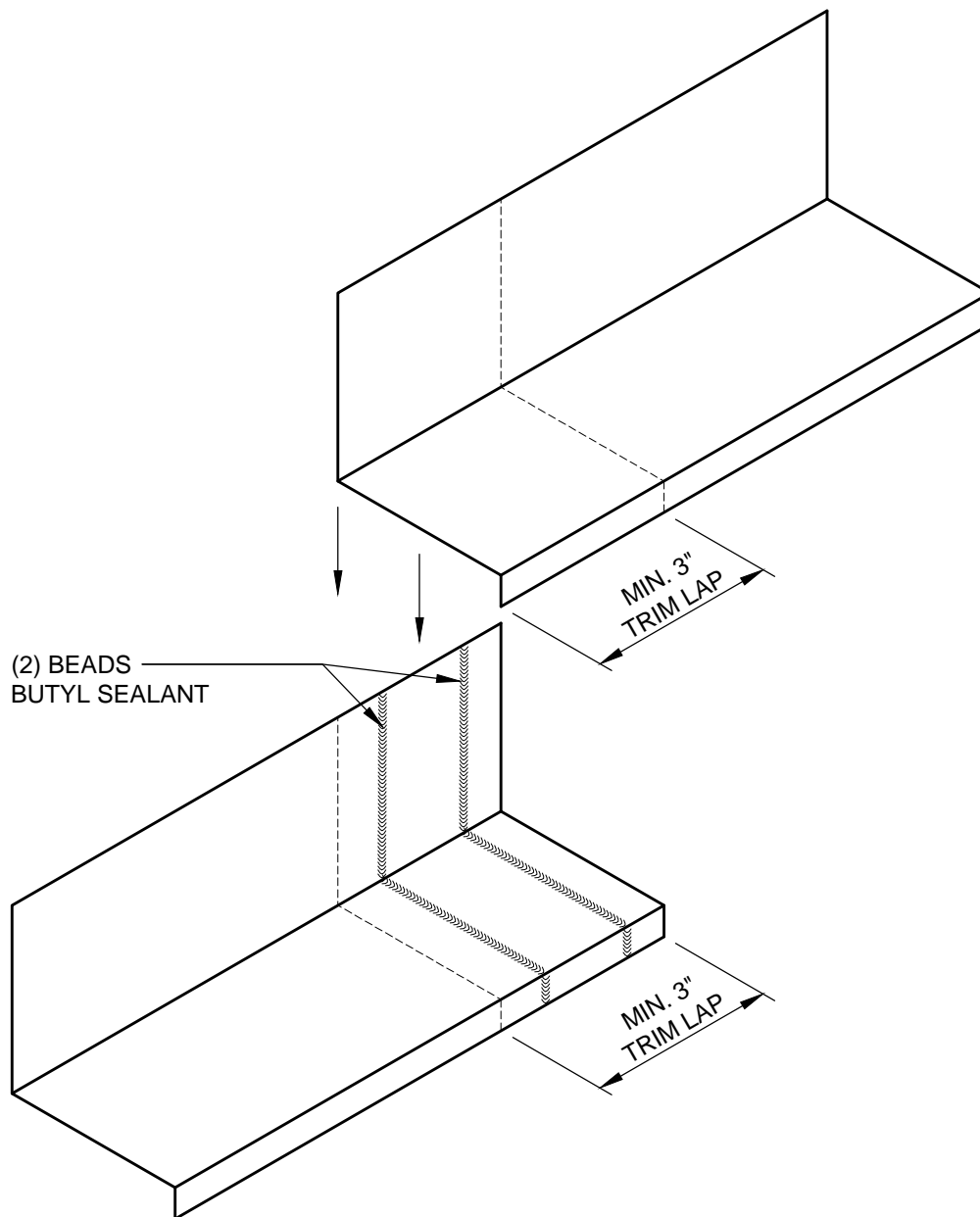

TRIM END LAP

DETAIL #: FRKPV-TL-01-MTLH

DATE: 2018



www.kingspanpanels.us
www.kingspanpanels.ca

VERTICAL KARRIER™ PANEL - FLAT RAIL - METAL FACADE

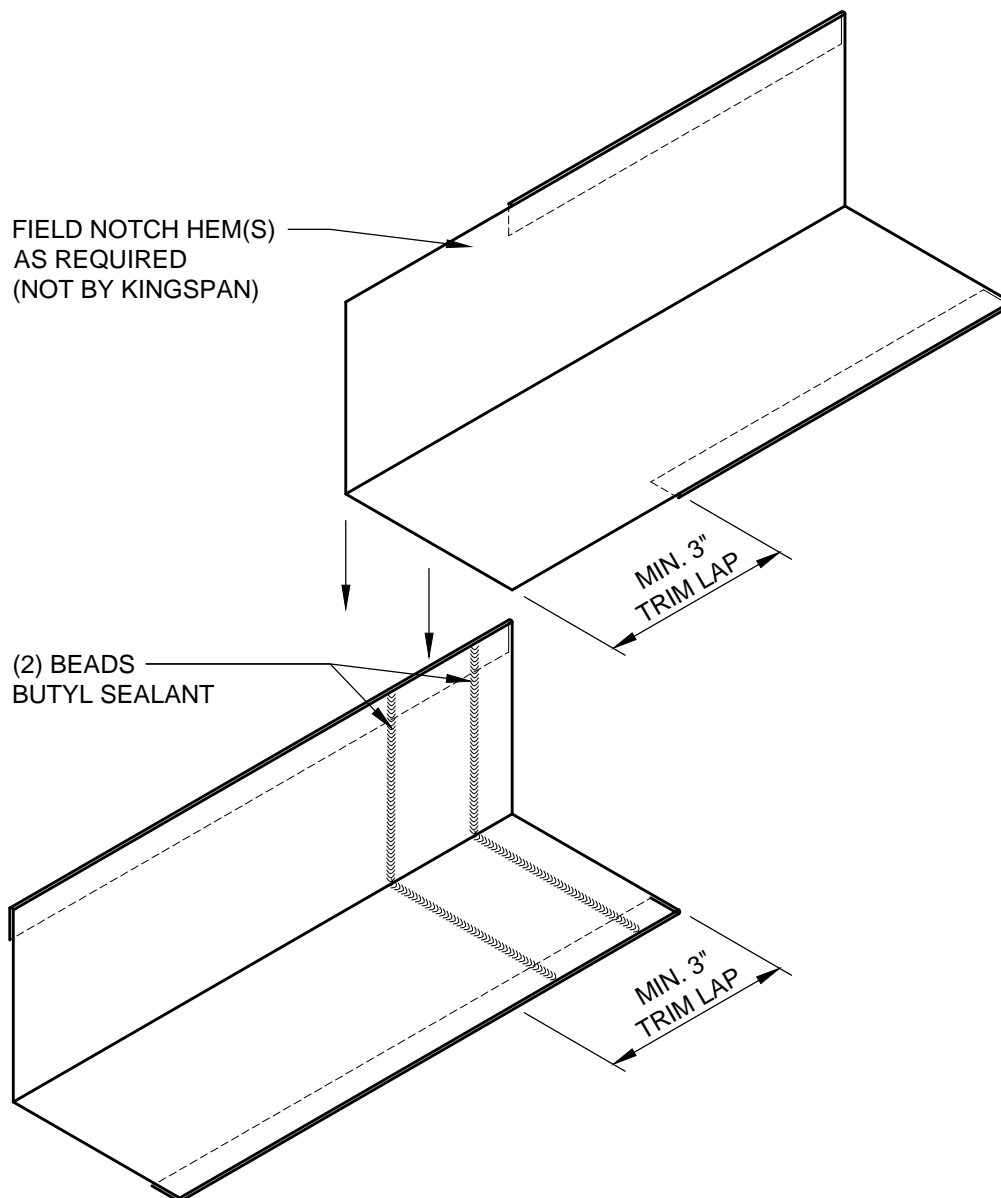

TRIM END LAP
WITH HEMS

DETAIL #: FRKPV-TL-02-MTLH

DATE: 2018



www.kingspanpanels.us
www.kingspanpanels.ca